

## DEPARTMENT OF NATURAL RESOURCES

101

NR 10

Kind of animal	Locality	Open season (all dates inclusive)	Daily bag limit	Possession limit
	i. Theresa zone	Oct. 1-Oct. 7 and Oct. 8 at 12:00 noon - Nov. 19 or until registered harvest reaches 3,000, whichever occurs first	Limited to one goose per 5-day period	The possession and season limits are 4.
	j. Rock Prairie zone	Oct. 8 - at 12:00 noon - Oct. 11; Oct. 19 - Dec. 11	1 1	2 2
	k. Mississippi river zone south of a line extending from the Chip-pewa river's center line	Oct. 8 at 12:00 noon - Oct. 11; Oct. 19 - Nov. 19 Nov. 20 - Dec. 23	1 1 2	2 2 4
2. All other species	Entire state	Concurrent with the wild duck seasons established in par. (b) and Canada goose seasons established in par. (g)	A total of 5 including 2 white-fronted geese and not more than the established daily limit for Canada geese or its subspecies during the open season on Canada geese	A total of 10 including 4 white-fronted geese and not more than the established possession or season limit on Canada geese or its subspecies during the open season on Canada geese

Note: Migratory bird rules, including seasons, limits, hours and areas where authorized, are established by emergency rule procedure in September of each year. The emergency rules will be published in their entirety in the official state newspaper and published in summary form in the current year migratory bird regulation pamphlet. Copies of the emergency rules may be obtained by contacting: State of Wisconsin Department of Natural Resources, Bureau of Wildlife Management, P.O. Box 7921, Madison, Wisconsin 53707.

(u) *Falconry special season.* Any person possessing a valid falconry permit and hunting license shall be restricted to the following migratory game bird seasons:

Kind of animal	Locality	Open season (all dates inclusive)	Daily bag limit	Possession limit
1. All species of wild duck except as provided in par. (a), mergansers and coots	Entire state	Beginning on the first season day established in s. NR 10.01 (1) (b) at 12:00 noon and continuing for 107 consecutive days	3	6
2. Gallinules, Sora rail, Virginia rail, common snipe and woodcock	Entire state	Sept. 1-Dec. 16	3	6

## (2) GAME BIRDS

Kind of animal and locality	Open season (all dates inclusive)	Limit
(a) <i>Ruffed grouse (partridge)</i>		
1. All that part of Wisconsin lying south of a line beginning at the junction of state highway 64 and the west boundary of St. Croix county, then east on highway 64 to its intersection with U.S. highway 45, then southeasterly on highway 45 to its intersection with U.S. highway 10, then east on highway 10 and continuing east to the junction with the east boundary of the state.	Beginning on the Saturday nearest September 15 and continuing through January 31	Daily bag 5; possession 10
2. Remainder of the state	Beginning on the Saturday nearest September 15 and continuing through December 31	Daily bag 5; 10 possession
(b) <i>Sharp-tailed grouse</i>		
1. All that part of Wisconsin lying north of a line beginning at the junction of state highway 64 and the west boundary of the state, then east along highway 64 to its junction with state highway 13, then south along highway 13 to its junction with state highway 29, then east along highway 29 ending in the city of Green Bay, except in the areas described in subds. 2. and 3.	Beginning on the Saturday nearest October 17 and continuing for 23 consecutive days	Daily bag d 3; possession 6
2. Closed areas established in s. NR 11.08	None	None
3. All that part of Price county enclosed by a line beginning at the intersection of state highway 70 and county highway F, then south on county highway F to its junction with Fleming's Rapids Road, then south on Fleming's Rapids Road to its junction with county highway W, then west on county highway W to its junction with Price Lakes Road, then north on Price Lakes Road to its junction with state highway 70, then east on state highway 70 to the point of beginning	None	None
4. Remainder of the state	None	None

Kind of animal and locality	Open season (all dates inclusive)	Limit
(c) <i>Pheasants</i>		
1. Cocks only — In all counties of the state except the properties specified in subd. 2 and s. NR 10.24 and within closed areas established in s. NR 11.14	Beginning on the Saturday nearest October 17 at 12:00 noon and continuing for 54 consecutive days	The bag limit for the first 14 days of the season is one each day with a possession limit of 2; thereafter the bag limit is 2 each day with a possession limit of 4
2. Cocks and hens — Within the following named properties as posted with department signs: a. Avoca (Iowa county) b. Blackhawk (Iowa county) c. Collins (Manitowoc county) d. Holland (Brown county)  e. Little Scarboro and Kewaunee (Kewaunee county) f. Mazomanie (Dane county) g. New Munster (Kenosha county) h. Pine River (Richland county) i. Theresa (Dodge-Washington counties) j. Witwen (Sauk county) k. Yellowstone (Lafayette county)	Beginning on the Saturday nearest October 17 at 12:00 noon and continuing for 54 consecutive days	The bag limit for the first 14 days of the season is one each day with a possession limit of 2; thereafter the bag limit is 2 each day with a possession limit of 4

3. Permit and tag requirement. No person may hunt cock or hen pheasants within the posted areas established in subd. 2. without possessing a current pheasant hunting permit decal, pheasant tags and valid Wisconsin hunting license. Permits and tags are valid only for the year of issue.

4. Permit application procedure. Application forms supplied by the department shall be completed and submitted by the applicant. No person may submit more than one application per year or an application containing false information.

5. Permit and tag issuance procedure. Permits and tags are not transferable or replaceable and may not be reused, altered or defaced. The department shall issue a numbered pheasant hunting permit and 10 tags to each applicant.

6. Permit validation. The numbered pheasant hunting permit decal shall be attached to the applicant's current year Wisconsin hunting license to be valid for use as described in this paragraph. Failure to follow the validation procedure invalidates the permit and tags.

7. Tagging requirement. When a cock or hen pheasant is killed on any lands described in subd. 2 and before it is carried by hand or transported in any manner, the hunter shall completely attach and seal the carcass tag, utilizing its own adhesive, around the leg of the pheasant.

Note: Special rules for the Bong state recreation area are established in s. NR 10.24.

Kind of animal and locality	Open season (all dates inclusive)	Limit
(d) <i>Hungarian partridge</i> In all counties of the state	Beginning on the Saturday nearest October 17 at 12:00 noon and continuing for 54 consecutive days.	Daily bag 3; possession 6
(e) <i>Bobwhite quail</i> In all counties of the state	Beginning on Saturday nearest October 17 at 12:00 noon and continuing for 54 consecutive days	Daily bag 5; possession 10
(f) <i>Wild turkey (zone hunting)</i> 1. Zones identified in subd. 2. and Ft. McCoy military reservation in Monroe county are open to turkey hunting by permit. The remainder of the state is closed to turkey hunting.	Beginning on the Wednesday nearest April 21 and continuing Wednesday through Sunday for 4 consecutive 5-day time periods except on Ft. McCoy military reservation where the season may continue for 26 consecutive days.	One male or bearded turkey per season by permit.

2. Hunting zones and permit numbers to be issued for each hunting period are:

Hunting Zones	Permits for subd. 1 season	Permits for each subd. 3. season
1	240	180
1A	280	280
2	660	400
3	700	450
4	700	550
5	300	100
6	300	none
7	200	none
8	200	none
9	300	180
10	340	280
11	400	none
12	250	none
13	200	none
31	150	none
32	100	none

Fort McCoy permit numbers are determined by Fort McCoy officials.

Kind of animal and locality	Open season (all dates inclusive)	Limit
3. Zones 1 and 1A to 5, 9 and 10 as described in s. NR 10.29	Beginning on the Wednesday nearest October 10 and continuing through Sunday for 3 consecutive 5-day time periods	One turkey of either sex per permit per year. Permit numbers are established in subd. 2

### (3) UPLAND GAME ANIMALS

Kind of animal and locality	Open season (all dates inclusive)	Limit
(a) <i>Gray and fox squirrels</i> In all counties of the state	Beginning on the Saturday nearest September 15 and continuing through January 31	Daily bag (total of both species) 5; possession 10

Kind of animal Locality	Open season (all dates inclusive)	Limit
(b) <i>Raccoon (resident hunting and trapping)</i>		
In all counties of the state	Beginning on the Saturday nearest October 17 and continuing through January 31.	None
(bm) <i>Raccoon (nonresident hunting)</i>		
In all counties of the state	Beginning on the Saturday nearest November 1 and continuing through January 31.	None
(c) <i>Cottontail, jackrabbit and snowshoe hare</i>		
1. Snowshoe hare in all counties of the state	All year	None
2. Cottontail		
a. All that part of Wisconsin lying north of U. S. highway 10 from Prescott to Waupaca and state highway 54 from Waupaca to Algoma	Beginning on the Saturday nearest September 15 and continuing through February 28	Daily bag 3; possession 6
b. In all other parts of the state	Beginning on the Saturday nearest October 17 at 12:00 noon and continuing through February 28	Daily bag 3; possession 6
c. In addition, there shall be an open season for hunting cottontails, except with the use of firearms, in Milwaukee county	All year	None
3. Jackrabbit		
In all counties of the state	Beginning on the Saturday nearest October 17 at 12:00 noon and continuing through November 15	Daily bag 3; possession 6
(d) <i>Bobcat (wildcat; hunting and trapping)</i>		
1. All that part of Wisconsin north of state highway 64	Beginning on the Saturday nearest October 17 and continuing through December 31	One per season by permit
2. Remainder of the state	None	None
(e) <i>Gun deer season.</i> As established by county and deer management unit (s. 10.28).		
As established by zone.	As established by zone.	The season limit is one deer regardless of the zone taken unless a second permit is issued under s. NR 10.104 (3) (b).
1. Zone "A"		
All that part of the state not otherwise listed in season zones "B" through "E".		

## WISCONSIN ADMINISTRATIVE CODE

Kind of animal	Locality	Open season (all dates inclusive)	Limit
a.	In the counties or parts of counties and deer management units of Buffalo (unit 59B portion), Brown, Calumet, Chippewa (unit 59B portion), Dane, Dodge, Door (Detroit, Plum, Rock, and Washington Islands only), Dunn (unit 59B portion), Green, Jefferson, Kenosha, Kewaunee, Lafayette, Manitowoc, Outagamie, Ozaukee, Pepin (unit 59B portion), Pierce (unit 59B, 60 and 60A portions), Racine, Rock, St. Croix (unit 59B and 60 portions), Sheboygan, Shawano (south of highway 29), Walworth, Washington, Waukesha, Waupaca, and Winnebago.	Shotgun season beginning on the Saturday preceding the Thanksgiving holiday and continuing for 9 consecutive days	One buck deer per season or hunter's choice permit limit
b.	Deer management unit 79 except Long island	Muzzle-loading firearm season October 1-31.	One deer per season, either sex.
c.	Deer management unit 82	Firearm season beginning on the Saturday preceding the Thanksgiving holiday and continuing for 9 consecutive days.	One buck deer with an unforked antler or hunter's choice permit limit.
d.	All other parts of Zone "A".	Firearm season beginning on the Saturday preceding the Thanksgiving holiday and continuing for 9 consecutive days.	One buck per season or hunter's choice permit limit.
2.	Zone "B"		
	Deer management units 59D, 61, 61B, 61C, 74A and 74B.		
a.	The Buffalo, La Crosse and Trempealeau portions of deer management unit 61, the La Crosse county portion of unit 74A and the Jackson, La Crosse and Monroe county portions of unit 59D.	Shotgun season beginning on the Saturday immediately preceding the Thanksgiving holiday and continuing for 2 consecutive days.	One deer per season, either sex.
		Firearm season beginning on the day immediately after the shotgun season described above and continuing for 7 consecutive days.	One buck deer per season.
b.	The Pepin and Pierce county portion of deer management unit 61.	Shotgun season beginning on the Saturday immediately preceding the Thanksgiving holiday and continuing for 2 consecutive days.	One deer per season, either sex.
		Shotgun season beginning on the day immediately after the shotgun season described above and continuing for 7 consecutive days.	One buck deer per season.
c.	Deer management until 61B (Trempealeau national wildlife refuge)	Shotgun season beginning on the Saturday immediately preceding the Thanksgiving holiday and continuing for 2 consecutive days.	One deer per hunter's choice permit per season.

Kind of animal Locality	Open season (all dates inclusive)	Limit	
d. Deer management unit 61C except during closed periods established by s. NR 11.031 (2) (b)	Shotgun season beginning on the Saturday immediately preceding the Thanksgiving holiday and continuing for 2 consecutive days.  Firearm season beginning on the day immediately after the shotgun season described above and continuing for 7 consecutive days.	One buck deer per season or hunter's choice permit limit.	
e. Deer management unit 74B and the Vernon county portion of deer management units 59D and 74A	Firearm season beginning on the Saturday immediately preceding the Thanksgiving holiday and continuing for 2 consecutive days.  Firearm season beginning on the day immediately after the firearm season described above and continuing for 7 consecutive days.	One deer per season, either sex.  One buck deer per season.	
3. Zone "C"	Governor Dodge (unit 70C), Blue Mound (unit 70D), and Perrot (unit 61A) state parks except areas posted closed to hunting.	Muzzle-loading firearm season beginning on the Saturday immediately preceding the Thanksgiving holiday and continuing for 9 consecutive days.	One deer per hunter's choice permit per season.
4. Zone "D"	Fort McCoy military reservation in Monroe county and Volk field military facility in Juneau county	Firearm, shotgun, muzzle-loader or handgun season as established by military permit approved by the department by August 1 annually.	One deer per season by military permit.
5. Zone "E"	Menominee county (unit 48)	Firearm, shotgun, muzzle-loader or handgun as established by the Menominee tribe, for tribal members only.	As established by the Menominee tribe.
(em) <i>Deer bow season</i> In all counties	Bow season beginning on the third Saturday in September and continuing through the Sunday immediately prior to the opening of the deer gun season	One deer per season, either sex.	
	Bow season beginning on the Saturday immediately following the close of the gun deer season through December 31		

## WISCONSIN ADMINISTRATIVE CODE

	Kind of animal Locality	Open season (all dates inclusive)	Limit
(f)	<i>Fox, all species</i>		
1.	North zone — All that part of Wisconsin north of state highway 64	Beginning on the Saturday nearest October 17 and continuing through January 31	None
2.	South zone — All that part of Wisconsin south of state highway 64	Beginning on the Saturday nearest November 1 and continuing through January 31	None
(g)	<i>Bear (gun and bow seasons). Zones A, B and C as described in s. NR 10.30.</i>	<p>With aid of bait only, subject to s. NR 10.07 (1) (g) beginning on the second Saturday in September and continuing for 21 consecutive days in even-numbered years and the third Saturday in September for 21 consecutive days in odd-numbered years.</p> <p>With aid of dogs only, in accordance with ss. NR 10.10 (1) (b) and 10.101, beginning on the second Saturday in September and continuing for 21 consecutive days in odd-numbered years and the third Saturday in September for 21 consecutive days in even-numbered years.</p> <p>With other methods of hunting without the aid of dogs or bait, beginning on the second Saturday in September and continuing for 28 consecutive days.</p>	One adult bear per permit issued under s. NR 10.102 taken by bow or firearm.



Kind of animal Locality	Open season (all dates inclusive)	Limit
(h) <i>Coyote</i>		
1. Hunting		
a. North of the highways established by subd. 3.	All year except closed during the gun season as established by s. NR 10.01 (3) (e) 1. d.	None
b. Remainder of the state	All year	None
2. Trapping		
a. North zone — All that part of Wisconsin north of state highway 64	Beginning on the Saturday nearest October 17 and continuing through January 31	None
b. South zone — All that part of Wisconsin south of state highway 64	Beginning on the Saturday nearest November 1 and continuing through January 31	None
3. Special closure — No person may hunt, shoot, shoot at, take, catch or pursue any coyote in that portion of the state north of the highways shown in the following map during the closed period described in subd. 1.		

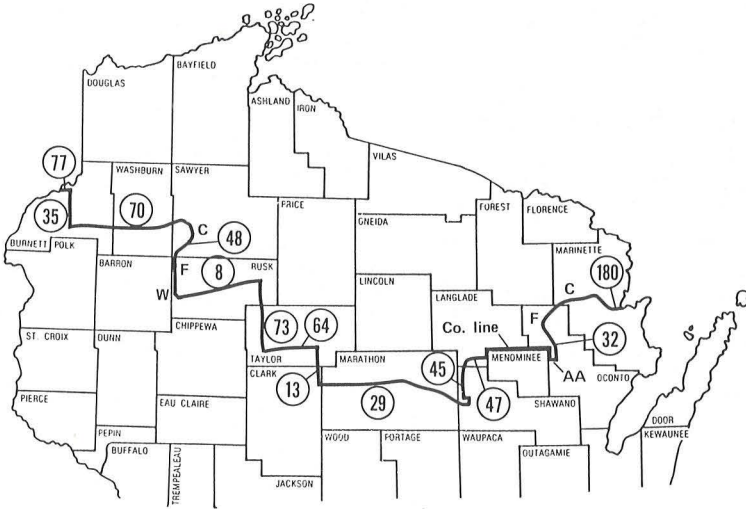

Kind of animal Locality	Open season (all dates inclusive)	Limit
<b>(4) FURBEARING ANIMALS</b>		
<i>(a) Muskrat and mink trapping.</i>		
1. 'North zone' — All that part of Wisconsin north of state highway 64	Beginning on the Saturday nearest October 21 and continuing through December 31	None
2. 'Central zone' — All that part of Wisconsin south of state highway 64 and north of the line beginning at the junction of U.S. highway 18 with the western boundary of the state, then east along highway 18 to its junction with U.S. highway 51, then north along highway 51 to its junction with state highway 60, then east along highway 60 to its junction with Ozaukee county highway "Q" extended east to Lake Michigan except as described in subd. 3	Beginning on the Saturday nearest October 28 and continuing through December 31	None
3. 'Winnebago zone' — All that part of Dodge county lying north of state highway 60, Fond du Lac, Outagamie, Waupaca, Waushara and Winnebago counties	Beginning on the Saturday nearest October 28 and continuing through March 15	None
4. 'Mississippi River zone' — All that part of Buffalo, Crawford, Grant, LaCrosse, Trempealeau, and Vernon counties lying east of the Chippewa river and west of the Burlington Northern railway	Beginning on the day following the close of the open season for ducks as established under sub. (1) (b)1. and continuing through January 15	None
5. 'South zone' — All other parts of the state	Beginning on the Saturday nearest November 4 and continuing through December 31	None

*encl  
am  
10/10/89*

**(b) Incidental take of muskrats.** During the closed season for muskrats, licensed trappers may retain for salvage any muskrats taken incidentally while trapping for beaver in the portions of the state open to beaver trapping as described in par. (c) and s. NR 19.85.

Kind of animal and locality	Open season (all dates inclusive)	Limit
<i>(c) Beaver trapping</i>	The opening date for the beaver trapping season is the same as the opening date for muskrat and mink as established in par. (a) and continuing through March 15	None
<i>(d) Otter trapping.</i>		
1. North zone — All that part of Wisconsin north of state highway 64	Beginning on the first Saturday in December and continuing through the first Sunday in March	2 per season by permit

Kind of animal	Locality	Open season (all dates inclusive)	Limit
2.	South zone — All that part of Wisconsin south of state highway 64	Beginning on the first Saturday in December and continuing through the first Sunday in March	One per season by permit
(dm) <i>Fisher trapping.</i>			
1.	Management zone A - Units 2, 3, 5 and 9 as described in s. NR 10.28	December 1-11	One per season by permit
2.	Management zone B - Units 7, 20, 28, 29A, 29B, 30 and 34 as described in s. NR 10.28	December 1-11	One per season by permit
3.	Management zone C - Units 38, 40, 42, 43 and 44 as described in s. NR 10.28	December 1-11	One per season by permit
4.	Remainder of the state - In all other parts of the state including the closed areas described in s. NR 11.10	None	None

(e) *Recording of fisher and otter.* 1. Tagging and permits. a. No person may trap or attempt to trap any fisher or otter unless having first applied for and received from the department a trapping permit and tag or tags authorizing such trapping.

b. Applications for permits and tags shall be postmarked no later than the Friday nearest October 1 or received by the department license section, 101 South Webster, Box 7924, Madison, WI 53707, no later than 4:30 p.m. on that Friday each year.

c. If the number of applications for fisher permits exceeds the number available in subd. 2, successful applicants shall be determined by random selection.

e. Each permit shall be numbered to correspond to the applicant's current trapping license and show the applicant's name and tag numbers.

f. No person may apply for more than one fisher permit or one otter permit.

2. Permit quota. a. Fisher quotas shall be primarily based on density estimates derived from annual track counts coupled with home range information based on telemetry data, numbers of fishers trapped during the previous year, and the sex, age and reproductive composition of harvested fishers. The department shall issue trapping permits in sufficient numbers to assure healthy, biological populations for each management zone indicated in subd. d.

b. In each management zone, the number of permits to be issued to harvest the desired numbers of fisher shall be based on an average of the trapper success rates from the most recent 3 previous seasons or by an average of fewer seasons where a 3-year average is not available. In establishing a quota for a zone without an adequate history of permits, the average success rates of similar quota areas shall be applied or the department shall estimate an anticipated success rate.

c. Permit success rates used to compute the number of permits to be issued for each quota shall be those calculated by the department from annual fisher season harvest reports.

The success rate formula is:

$$\text{Success rate} = \frac{\text{Number of fisher harvested}}{\text{Number of permits issued}}$$

The permit number formula is:

$$\text{Permit number} = \frac{\text{Quota fisher to be harvested}}{\text{Trapper success rate}}$$

d. Fisher management zones and overwinter population goals expressed in terms of fisher per square mile of fisher range are as follows:

<u>Management Zones</u>	<u>Fisher Goal</u>
A, B and C	1 per 4 square miles

3. Tagging procedure. a. Each person shall immediately upon possessing a fisher or an otter, attach and lock a valid tag, issued by the department, through the opening of the mouth to the opening of the eye, immediately beneath the skin.

b. No person may have a fisher or an otter pelt in possession or under control unless the person trapping the animal attaches the tag as required by this subdivision.

c. The tag shall remain attached to the pelt until removed by a fur dresser or taxidermist at time of preparation.

4. Fisher exhibition. Unless otherwise authorized by the department, each person who has trapped a fisher shall exhibit the pelt separated from the carcass along with the carcass to an authorized department representative in the county in which the animal was trapped, or in an adjoining county, no later than 5 days after the close of the fisher season. The fisher carcass shall be retained by the department.

5. Otter exhibition. Each person who has trapped an otter shall exhibit each pelt to an authorized department representative in the county in which the animal was trapped, or in an adjoining county, but within the area open to otter trapping, no later than 5 days after the close of the otter season.

6. Registration. The department shall inspect the pelt, attach and lock a registration tag to the head of all lawfully taken and possessed fisher and otter.

7. Possession and transfer restrictions. No person may:

a. Possess raw fisher or otter pelts later than 5 days after the close of the fisher and otter seasons to the opening date of the following fisher and otter seasons without a registration tag attached and locked to the head of the animal.

b. Transfer, give, trade, sell or purchase any fisher or otter pelt without a registration tag being attached and locked to the head of the pelt.

8. Fisher or bobcat intended for mounting. Persons exhibiting fisher under subd. 4. or bobcat under s. NR 10.145 (3) who intend to have the fisher or bobcat mounted by a taxidermist may exhibit the fisher or bobcat to the department for registration in whole carcass condition without

separating the pelt and need not surrender the skinned carcass to the department until after the taxidermist has separated the pelt.

**History:** 1-2-56; am. (3) (g), Register, August, 1985, No. 356, eff. 9-1-85; r. and recr. (intro.), (1) (n), (2) (b), (3) (d) 2. c. and (3) (e) 7., am. (2) (f) 1. and 2., (3) (e) 2. intro. and d. and 9. e., Register September, 1985, No. 357, eff. 10-1-85; emerg. r. and recr. (1) (g) 1. a, cr. (1) (g) 1. a., eff. 10-19-85; r. and recr. (4) (a) 4., am. (2) (f), Register, January, 1986, No. 361, eff. 2-1-86, except (4) (a) 4. eff. 3-1-86; r. and recr. (1) (b), (g), (l) 2. b. and 5., (tm) 3., am. (1) (u) 1., Register, April, 1986, No. 364, eff. 5-1-86; r. and recr. (3) (g), Register, June, 1986, No. 366, eff. 7-1-86; am. (1) (l) 2. and 3. b., (3) (e) (intro.) and (4) (e) 4., r. and recr. (3) (e) 2. and 6., (3) (em) and (4) (e) 1. b., r. (4) (d) 3. to 5., Register, August, 1986, No. 368, eff. 9-1-86; emerg. r. and recr. (1) (a), (b), (g), (l) 2. b. and 5., (tm) 3. and (u) 1., cr. (1) (e) 3. c., eff. 9-12-86; r. and recr. (3) (e) intro. and 1. to 6., am. (3) (e) 9. e. and (4) (e) 2. intro., Register, October, 1986, No. 370, eff. 11-1-86; r. and recr. (1) (a), (b), (g), (l) 2. b. and 5., (tm) 3., (u) 1., cr. (1) (l) 3. c., Register, January, 1987, No. 373, eff. 2-1-87; am. (2) (f) 1. and r. and recr. (2) (f) 2., Register, February, 1987, No. 374, eff. 3-1-87; cr. (4) (e) 8., Register, March, 1987, No. 375, eff. 4-1-87; r. (1) (q) and (r), r. and recr. (3) (g) and (4) (c), Register, July, No. 379, eff. 8-1-87; emerg. r. (1) (a), r. and recr. (1) (b), (c) 2., (g), (l) 2. b. and 5., (tm) 2., 3. and 4., (u) 1., eff. 9-25-87; am. (2) (f) 1. and 2., (3) (e) 9. e., r. and recr. (3) (h) 1. and (4) (e) 2., cr. (3) (h) 3., Register, October, 1987, No. 382, eff. 11-1-87; r. (1) (a), r. and recr. (1) (b), (c) 2., (g), (l) 2. b., and 5., (tm) 2. to 5., and (u) 1., Register, December, 1987, No. 384, eff. 1-1-88; r. and recr. (2) (f) 2., Register, January, 1988, No. 385, eff. 2-1-88; r. and recr. (4) (b), am. (4) (c), Register, June, 1988, No. 390, eff. 7-1-88; renum. (1) (h) to be NR 10.125 (6), r. (1) (i) to (tm), (3) (e) 7. and 9., am. (1) (u) 1., r. and recr. (2) (b) 2., Register, July, 1988, No. 391, eff. 8-1-88; emerg. cr. (1) (a), r. and recr. (1) (b), (c) and (g) eff. 9-21-88; am. (intro.) and (2) (c) 1., Register, October, 1988, No. 394, eff. 11-1-88. cr. (2) (f) 3., Register, October, 1988, No. 394, eff. 1-1-89; cr. (1) (a), r. and recr. (1) (b), (c) and (g), Register, January, 1989, No. 397, eff. 2-1-89; r. and recr. (2) (f) 1. and 2., Register, March, 1989, No. 399, eff. 4-1-89; am. (3) (e) (intro.), r. (4) (e) 1. d., Register, July, 1989, No. 403, eff. 8-1-89.

**Note:** For a complete history of s. NR 10.01 from 1-2-56 through 11-30-73 see the history note following s. NR 10.01 published in November 1973, Register. For a complete history of s. NR 10.01 from 12-1-73 through 7-31-85 see the history note following s. NR 10.01 published in the July, 1985 Register.

**NR 10.02 Protected wild animals.** The following wild animals are designated protected. No person may take, attempt to take, transport or possess any protected wild animal at any time unless expressly authorized by the department.

- (1) Cougar, badger, moose, elk, wolverine and flying squirrel.
- (2) Endangered or threatened species listed in ch. NR 27.
- (3) White deer (monocolored).
- (4) Woodchuck except as provided in s. 29.24, Stats.
- (5) Prairie chicken, Canada spruce grouse (spruce hen), mourning doves, swans, cranes, bitterns, plovers, kingfishers, cormorants, herons, sandpipers and grebes.
- (6) Eagles, hawks, falcons, and owls except as provided in ch. NR 18.
- (7) Hen pheasants except as expressly provided in this chapter.
- (8) Any other wild bird not specified in this chapter.

**History:** 1-2-56; am. (2), Register, August, 1956, No. 8, eff. 9-1-56; am. (1), Register, August, 1957, No. 20, eff. 9-1-57; am. (1) and (2), Register, August, 1958, No. 32, eff. 9-1-58; am. (1) emerg. eff. 9-20-58; am. (1), Register, August, 1959, No. 44, eff. 9-1-59; am. (2), cr. (3), Register, September, 1965, No. 117, eff. 10-1-65; am. (2), Register, March, 1966, No. 123, eff. 4-1-66; am. (1), Register, August, 1967, No. 140, eff. 9-1-67; renum. to be NR 10.02; am. (2), Register, June, 1970, No. 174, eff. 7-1-70; am. (1), Register, September, 1972, No. 201, eff. 10-1-72; r. (3), Register, December, 1977, No. 264, eff. 1-1-78; r. and recr. Register, August, 1979, No. 284, eff. 9-1-79; am. (1), Register, September, 1983, No. 333, eff. 10-1-83; am. (1), Register, July, 1985, No. 355, eff. 8-1-85; cr. (intro.) Register, September, 1985, No. 357, eff. 10-1-85.

*emergency*  
*no*  
*10/16/85*

**NR 10.03 Birds causing depredation.** (1) **APPLICATION.** The following named birds have been determined by the department to be birds committing depredation or about to commit depredation at all times to and upon ornamental or shade trees, agricultural crops, livestock or wildlife, and when concentrated in large numbers that they many constitute a health hazard or other nuisance:

- (a) Red-winged blackbirds.
- (b) Grackles.
- (c) Crows.
- (d) Cowbirds.

(2) **PERMITS.** Such birds may be taken at all times without need for either a federal or state permit.

(3) **INSPECTION OF PREMISES.** Any person taking such birds shall at all reasonable times, including during actual operation, permit any federal or state game law enforcement officer, free and unrestricted access on the premises over which such operations have been or are being conducted, and shall furnish promptly to such officer whatever information may be required about said operation.

(4) **DISPOSITION.** Birds killed pursuant to this subsection and their plumage shall not be sold or offered for sale.

**History:** 1-2-56; am. Register, August, 1956, No. 8, eff. 9-1-56; am. Register, August, 1966, No. 128, eff. 9-1-66; r. and recr., Register, August, 1967, No. 140, eff. 9-1-67; renum. to be NR 10.03; r. (1), Register, June, 1970, No. 174, eff. 7-1-70; r. and recr. Register, August, 1979, No. 284, eff. 9-1-79.

**NR 10.04 Unprotected wild animals.** The following wild animals are designated unprotected. No closed season, bag limit, size limit or possession limit applies to these animals.

**Note:** A valid hunting or trapping license must be obtained before taking any unprotected animal by a gun discharged from the shoulder, handgun, pellet gun, bow and arrow, falconry, steel-jawed traps, Conibear traps or live traps. A department approval is required before any unprotected animal may be taken by any means not specified in this paragraph.

- (1) Opossum, skunk and weasel.
- (2) Starlings, English sparrows, coturnix quail and chukar partridge.
- (3) Any other wild animal not specified in this chapter.

**History:** 1-2-56; am. (1) Register, August, 1957, No. 20, eff. 9-1-57; am. (2), Register, August, 1958, No. 32, eff. 9-1-58; renum. to be NR 10.04; am. (1) and (2), Register, June, 1970, No. 174, eff. 7-1-70; am. (1), Register, August, 1972, No. 200, eff. 9-1-72; r. and recr. Register, No. 251, eff. 12-1-76; r. and recr. Register, August, 1979, No. 284, eff. 9-1-79; am. (1), Register, October, 1980, No. 298, eff. 11-1-80; cr. (intro.), Register, September, 1985, No. 357, eff. 10-1-85.

**NR 10.05 Highways.** (1) **GENERAL HUNTING.** No person may hunt within 50 feet of a roadway's center except as provided in s. 167.31, Stats.

**Note:** The exceptions provided by s. 167.31, Stats., allows any person to legally hunting small game with a muzzle-loading firearm or shotgun loaded with shotshells containing shot size BB or smaller if the roadway is surfaced with anything other than concrete or blacktop.

(2) **WATERFOWL AND COOT HUNTING.** It shall be unlawful to hunt waterfowl or coot from any public roads or railroads including the respective Register, July, 1989, No. 403

tive rights-of-way along or within the area described as the Horicon zone in s. NR 10.31 (4).

**History:** 1-2-56; am. (1) and (2), Register, August, 1956, No. 8, eff. 9-1-56; am. (1) and (2), Register, August, 1957, No. 20, eff. 9-1-57; r. (1) and (2) and recr. (1), Register, August, 1958, No. 32, eff. 9-1-58; cr. (2), Register, September, 1960, No. 57, eff. 10-1-60; cr. (3), Register, August, 1963, No. 92, eff. 9-1-63; r. and recr. (2), Register, September, 1966, No. 129, eff. 10-1-66; emerg. am. (2), eff. 9-1-67; emerg. am. (2), eff. 9-30-68; emerg. am. (2), eff. 8-30-69; am. (2), Register, November, 1969, No. 167, eff. 12-1-69; renum. to be NR 10.05; cr. (4) and (5), Register, June, 1970, No. 174, eff. 7-1-70; emerg. am. (2), eff. 9-19-73; emerg. am. (2), eff. 9-24-75; am. (2), Register, May, 1976, No. 245, eff. 6-1-76; r. and recr. (1) am. (2) and r. (3), (4) and (5), Register, May, 1977, No. 257, eff. 6-1-77; am. (2), Register, February, 1978, No. 266, eff. 3-1-78; am. (1), Register, September, 1979, No. 285, eff. 10-1-79; am. (2), Register, July, 1989, No. 403, eff. 8-1-89.

**NR 10.06 Hunting hours.** (1) **GENERAL HUNTING.** All hunting hours, when specified in this chapter, mean Central Standard Time, and the daily opening (a.m.) and closing (p.m.) hours listed shall apply to the entire state.

(2) **HUNTING ZONES.** (a) *General.* General hunting hour zones are established as follows:

**Zone**

- A—all that part of the state lying east of 88°-00' longitude.
- B—all that part of the state lying between 88°-00' and 89°-00' long.
- C—all that part of the state lying between 89°-00' and 90°-00' long.
- D—all that part of the state lying between 90°-00' and 91°-00' long.
- E—all that part of the state lying between 91°-00' and 92°-00' long.
- F—all that part of the state lying west of 92°-00' longitude.

(b) *General prohibition.* Except as provided in subs. (4) and (6) to (8), no person may hunt or shoot any species of game on which an open season is established on any day during the open season before the time established by the a.m. column or after the time established by the p.m. column in any hunting hour zone.

(c) *General prohibition.* Except as provided in subs. (3) through (6), no person may hunt or shoot any species of game on which an open season is established on any day during the open season before the time established by the a.m. column or after the time established by the p.m. column in any hunting hour zone.

(3) **SMALL GAME HUNTING.** (a) *Formula.* The hunting hours for pursuing small game in Zone A are listed in par. (b). Small game hunting hours for other zones are obtained by adding minutes to the Zone A a.m. and p.m. columns as follows:

Zone - Adjustment

- B - add 4 minutes.
- C - add 8 minutes.
- D - add 12 minutes.
- E - add 16 minutes.
- F - add 20 minutes.

## (b) General Hunting Hours C.S.T.

	September		October		November		December		January		February	
	A.M.	P.M.	A.M.	P.M.	A.M.	P.M.	A.M.	P.M.	A.M.	P.M.	A.M.	P.M.
1	4:42	6:27	5:18	5:31	5:57	4:40	6:36	4:12	6:57	4:21	6:38	5:00
2	4:43	6:26	5:19	5:30	5:59	4:38	6:37	4:11	6:57	4:22	6:37	5:02
3	4:45	6:24	5:20	5:28	6:00	4:37	6:39	4:11	6:57	4:23	6:35	5:04
4	4:46	6:22	5:21	5:26	6:01	4:36	6:40	4:11	6:57	4:24	6:34	5:06
5	4:47	6:20	5:22	5:24	6:03	4:34	6:41	4:11	6:57	4:25	6:33	5:08
6	4:48	6:18	5:24	5:22	6:04	4:33	6:42	4:10	6:57	4:26	6:32	5:10
7	4:49	6:16	5:25	5:21	6:05	4:32	6:43	4:10	6:57	4:27	6:31	5:11
8	4:50	6:15	5:26	5:19	6:07	4:31	6:44	4:10	6:56	4:28	6:30	5:12
9	4:52	6:13	5:27	5:17	6:08	4:29	6:45	4:10	6:56	4:29	6:29	5:14
10	4:53	6:11	5:29	5:15	6:10	4:28	6:46	4:10	6:56	4:30	6:28	5:16
11	4:54	6:09	5:30	5:13	6:11	4:27	6:47	4:10	6:55	4:31	6:26	5:17
12	4:55	6:07	5:31	5:12	6:12	4:26	6:47	4:10	6:55	4:32	6:25	5:18
13	4:56	6:05	5:32	5:10	6:14	4:25	6:48	4:10	6:55	4:34	6:24	5:19
14	4:57	6:03	5:34	5:08	6:15	4:24	6:49	4:11	6:54	4:35	6:22	5:21
15	4:59	6:01	5:35	5:06	6:16	4:23	6:50	4:11	6:54	4:36	6:21	5:23
16	5:00	6:00	5:36	5:05	6:18	4:22	6:50	4:11	6:53	4:37	6:20	5:24
17	5:01	5:58	5:38	5:03	6:19	4:21	6:51	4:11	6:53	4:39	6:18	5:25
18	5:02	5:56	5:39	5:01	6:20	4:20	6:52	4:12	6:52	4:40	6:16	5:27
19	5:03	5:54	5:40	5:00	6:22	4:19	6:52	4:12	6:51	4:41	6:15	5:28
20	5:04	5:52	5:41	4:58	6:23	4:18	6:53	4:13	6:51	4:42	6:13	5:29
21	5:06	5:50	5:43	4:56	6:24	4:18	6:54	4:13	6:50	4:44	6:12	5:30
22	5:07	5:48	5:44	4:55	6:25	4:17	6:54	4:13	6:49	4:45	6:10	5:32
23	5:08	5:46	5:45	4:53	6:27	4:16	6:55	4:14	6:48	4:46	6:09	5:33
24	5:09	5:45	5:47	4:52	6:28	4:15	6:55	4:15	6:47	4:48	6:08	5:34
25	5:10	5:43	5:48	4:50	6:29	4:15	6:55	4:15	6:46	4:49	6:06	5:35
26	5:12	5:41	5:49	4:49	6:30	4:14	6:56	4:16	6:46	4:51	6:04	5:37
27	5:13	5:39	5:51	4:47	6:32	4:14	6:56	4:17	6:45	4:52	6:02	5:38
28	5:14	5:37	5:52	4:46	6:33	4:13	6:56	4:17	6:44	4:53	6:01	5:39
29	5:15	5:35	5:53	4:44	6:34	4:13	6:57	4:18	6:43	4:55		
30	5:16	5:33	5:55	4:43	6:35	4:12	6:57	4:19	6:42	4:56		
31			5:56	4:41			6:57	4:20	6:40	4:58		

(4) MIGRATORY GAME BIRD HUNTING. The hunting zones for pursuing migratory game birds is established in par. (a) and hunting hours are established in the following table with the following exceptions:

1. All waterfowl hunting starts at noon on the first day of the duck hunting season established in s. NR 10.01 (1) (b).

2. The hunting hours in the Theresa goose management zone close at 1:00 p.m. daily except on the first day of the duck hunting season established in s. NR 10.01 (1) (b) when the hunting hours close as shown in the table.



## Migratory Game Bird Hunting Hours C.S.T.

DAY	September		October		November		December	
	A.M.	P.M.	A.M.	P.M.	A.M.	P.M.	A.M.	P.M.
1	5:12	6:27	5:48	5:31	6:27	4:40	7:05	4:12
2	5:13	6:26	5:49	5:30	6:29	4:38	7:07	4:11
3	5:15	6:24	5:50	5:28	6:30	4:37	7:09	4:11
4	5:16	6:22	5:51	5:26	6:31	4:36	7:10	4:11
5	5:17	6:20	5:52	5:24	6:33	4:34	7:11	4:11
6	5:18	6:18	5:54	5:22	6:34	4:33	7:12	4:10
7	5:19	6:16	5:55	5:21	6:35	4:32	7:13	4:10
8	5:20	6:15	5:56	5:19	6:37	4:31	7:14	4:10
9	5:22	6:13	5:57	5:17	6:38	4:29	7:15	4:10
10	5:23	6:11	5:59	5:15	6:40	4:28	7:16	4:10
11	5:24	6:09	6:00	5:13	6:41	4:27	7:17	4:10
12	5:25	6:07	6:01	5:12	6:42	4:26	7:17	4:10
13	5:26	6:05	6:02	5:10	6:44	4:25	7:18	4:10
14	5:27	6:03	6:04	5:08	6:45	4:24	7:19	4:11
15	5:29	6:01	6:05	5:06	6:46	4:23	7:20	4:11
16	5:30	6:00	6:06	5:05	6:48	4:22	7:20	4:11
17	5:31	5:58	6:08	5:03	6:49	4:21	7:21	4:11
18	5:32	5:56	6:09	5:01	6:50	4:20	7:22	4:12
19	5:33	5:54	6:10	5:00	6:52	4:19	7:22	4:12
20	5:34	5:52	6:11	4:58	6:53	4:18	7:23	4:13
21	5:36	5:50	6:13	4:56	6:54	4:18	7:24	4:13
22	5:37	5:48	6:14	4:55	6:55	4:17	7:24	4:13
23	5:38	5:46	6:15	4:53	6:57	4:16	7:25	4:14
24	5:39	5:45	6:17	4:52	6:58	4:15	7:25	4:15
25	5:40	5:43	6:18	4:50	6:59	4:15	7:25	4:15
26	5:42	5:41	6:19	4:49	7:00	4:14	7:26	4:16
27	5:43	5:39	6:21	4:47	7:02	4:14	7:26	4:17
28	5:44	5:37	6:22	4:46	7:03	4:13	7:26	4:17
29	5:45	5:35	6:23	4:44	7:04	4:13	7:27	4:18
30	5:46	5:33	6:25	4:43	7:05	4:12	7:27	4:19
31			6:26	4:41			7:27	4:20

(5) BIG GAME HUNTING. The start and close of hunting hours for pursuing bear and deer shall be as follows:

(a) *Starting hours.* Morning hunting hours shall start as established in the following table:

Dates	A.M. Shooting hours
September 1-17	5:00
September 18-October 1	5:15
October 2-9	5:30
October 10-16	5:30
October 17-25	5:45
October 26-November 6	6:00
November 7 through the day before the gun deer season	6:15
First day of gun deer season through December 31	6:30

(b) *Closing hours.* Gun deer hunting hours shall close at 4:30 p.m. daily. Bow and firearm bear hunting and bow deer hunting shall close at times determined by adding minutes to the small game hunting table p.m. column in sub. (3) as follows:

Zone - Adjustment

- A - add 15 minutes
- B - add 19 minutes
- C - add 23 minutes
- D - add 27 minutes
- E - add 31 minutes
- F - add 35 minutes

(6) PHEASANT HUNTING. Pheasant hunting hours shall close at 2:00 p.m. daily within the posted boundaries of the following properties beginning the second day of the pheasant hunting season established in s. NR 10.01 (2) (c) and continuing for 13 consecutive days.

- (a) Allenton (Washington county)
- (b) Brooklyn (Dane and Green counties)
- (c) Collins (Manitowoc county)
- (d) Dunnville (Dunn county)
- (e) Goose Lake (Dane county)
- (f) Holland (Brown county)
- (g) Horicon (Dodge county)
- (h) Killsnake (Calumet and Manitowoc counties)
- (i) Little Scarboro — Kewaunee (Kewaunee county)
- (j) Mazomanie (Dane county)
- (jm) Muddy Creek (Dunn county)
- (k) New Munster (Kenosha county)
- (l) Theresa (Dodge and Washington counties)
- (m) Tichigan (Racine county)
- (n) Vernon (Waukesha county)
- (o) White River (Green Lake and Marquette counties)
- (p) Witwen (Sauk county)

(7) WILD TURKEY HUNTING. The hunting hours for pursuing wild turkeys shall be as follows:

- (a) *Spring.* ½ hour before sunrise to 12:00 noon each day.
- (b) *Fall.* The same as small game hunting hours established in sub. (3)

(8) EXCEPTIONS. There are no hunting hour restrictions for pursuing coyote, fox, raccoon and all wild animals for which no closed season is established except as follows:

(a) *Gun deer season.* Small game hunting hours established in sub. (3) shall apply during the gun deer season established in s. NR 10.01 (3) (e).

(b) *Bow deer season.* Small game hunting hours established in sub. (3) shall apply to archers pursuing species other than deer.

(c) *Bear season.* Small game hunting hours established in sub. (3) shall apply to archers pursuing species other than bear.

Note: Small game hunting hours apply to archers when the deer and bear seasons are open concurrently.

History: 1-2-56; am. (2); cr. (2m), Register, August, 1956, No. 8, eff. 9-1-56; am. (2m), Register, August, 1957, No. 20, eff. 9-1-57; am. (2), (2m) and (3), Register, August, 1958, No. 32, eff. 9-1-58; r. and recr. Register, August, 1959, No. 44, eff. 9-1-59, am. (2), cr. (2m) Register, Sept. 1959, No. 45, eff. 10-1-59; am. (2) and r. (2m), Register, September 1960, No. 57, eff. 10-1-60; am. (2), cr. (2m), Register, September, 1989, No. 397

ber, 1961, No. 69, eff. 10-1-61; r. and recr. (2) and (2m), Register, August, 1962, No. 80, eff. 9-1-62; r. and recr. Register, August, 1965, No. 116, eff. 9-1-65; am. (3), emerg. eff. 9-5-65; am. (2), Register, March, 1966, No. 123, eff. 4-1-66; r. and recr. Register, August, 1966, No. 128, eff. 9-1-66; r. cr. (2); cr. (4) Register, September, 1966, No. 129, eff. 10-1-66; r. and recr. (2) and (3), Register, August, 1967, No. 140, eff. 9-1-67; renum. to be NR 10.06; r. (4), Register, June, 1970, No. 174, eff. 7-1-70; am. (3), Register, August, 1971, No. 188, eff. 9-1-71; am. (3), Register, September, 1972, No. 201, eff. 10-1-72; am. (2), (3), Register, August, 1973, No. 212, eff. 9-1-73; am. (2), Register, September, 1973, No. 213, eff. 10-1-73; am. (3), Register, March, 1975, No. 231, eff. 4-1-75; emerg. am. (2) (d), eff. 9-24-75; am. (3), Register, October, 1975, No. 238, eff. 11-1-75; am. (2) (d) (eff. 6-1-76), am. (2) (c), Register, May, 1975, No. 245, eff. 8-15-76; am. (2) (d) and (3), Register, November, 1976, No. 251, eff. 12-1-76; am. (2) (a), Register, May, 1977, No. 257, eff. 6-1-77; r. and recr. (2) (d), Register, February, 1978, No. 266, eff. 3-1-78; am. (2) (c) and (e), Register, October, 1980, No. 298, eff. 11-1-80; am. (2) (c) and cr. (4) and (5), Register, November, 1982, No. 323, eff. 12-1-82; am. (2) (c) and cr. (6), Register, March, 1984, No. 339, eff. 4-1-84; am. (2) (d), Register, April 1985, No. 352, eff. 5-1-85; cr. (6) (jm), Register, October, 1986, No. 370, eff. 11-1-86; emerg. am. (2) (d), eff. 9-25-97; am. (2) (d), Register, December, 1987, No. 384, eff. 1-1-88; r. and recr. (2) (b), (3) to (5), r. (2) (d), renum. (2) (e) to be (3) (b), cr. (7) and (8), Register, October, 1988, No. 394, eff. 1-1-89; r. and recr. (4), Register, January 1989 No. 397 eff. 2-1-89.

**NR 10.07 General hunting. (1) PROHIBITED METHODS. No person shall:**

(a) *Aircraft.* Hunt with the aid of an airplane, including the use of an airplane to spot, rally or drive wild animals for hunters on the ground.

(b) *Devices.* 1. Place, operate or attend, spread, or set any net, pitfall, snare, spring gun, pivot gun, swivel gun, or other similar contrivance for the purpose of catching or which might catch, take or ensnare wild animals.

2. Use or possess any snare, trap or device designed or used for the purpose of driving rabbits out of their holes or dens.

(d) *Molesting.* Molest the nest or den of any squirrel.

(e) *Ferret.* Use or possess any ferret while hunting.

(f) *Retrieval.* Fail to make every reasonable effort to retrieve all wild animals killed or crippled; and until such effort is made, such wild animals shall be included in the daily bag.

(g) *Baiting.* 1. Place, use or hunt over bait contained within metal, paper, plastic, glass, wood or other nondegradable materials.

2. Except as established in s. NR 10.12 (1) (h), use any bait material for attracting wild animals other than fruit, vegetables, grains, pastry or liquid scent. All such solid material shall be confined to a hole in the ground measuring no more than 2 feet square.

3. Place or hunt over bait or liquid scent within 50 yards of any trail, road or campsite used by the public.

4. Exception: This subsection does not prohibit hunting over bait materials deposited by natural vegetation or found solely as a result of normal agricultural practices.

(h) *Salt.* Hunt by the use or aid of salt.

(i) *Dog use.* Hunt or pursue any free-roaming wild animal with the aid of dog or dogs May 1 to June 30 in that portion of the state north of the highways shown on the following map except for dog trials and training under permit as established by ch. NR 17:

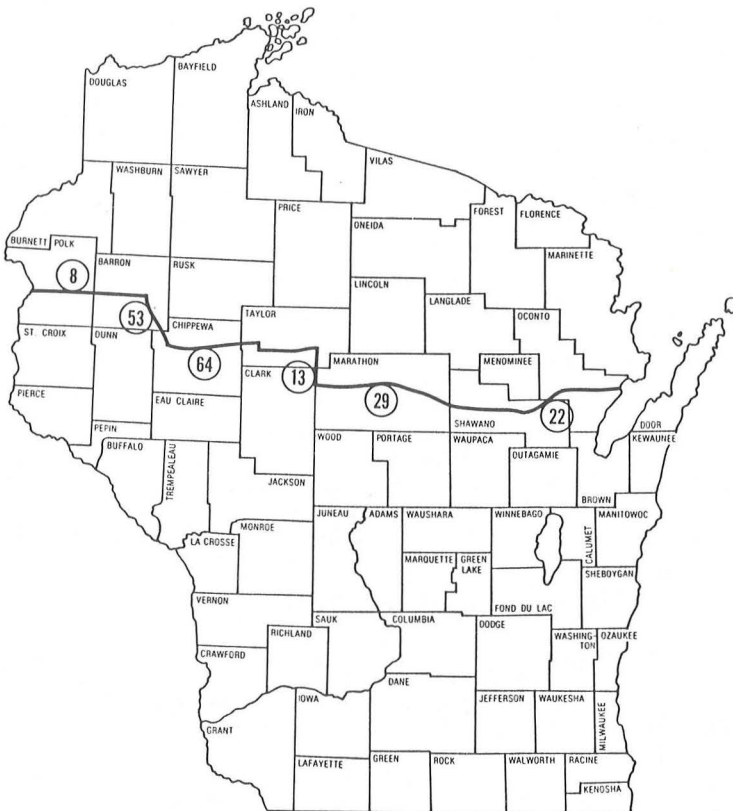

History: 1-2-56; am. (2), Register, August, 1957, No. 20, eff. 9-1-57; am. (5), Register, August, 1958, No. 32, eff. 9-1-58; r. and recr. (1) and (3), Register, August, 1960, No. 56, eff. 9-1-60; cr. (8), Register, September, 1961, No. 69, eff. 10-1-61; am. (1), Register, September, 1965, No. 117, eff. 10-1-65; r. (6), am. (7) (a), Register, August, 1966, No. 128, eff. 9-1-66; r. and recr. (2), Register, August, 1968, No. 152, eff. 9-1-68; renum. to be NR 10.07; am. (1), Register, June, 1970, No. 174, eff. 7-1-70; am. (2) (a), r. and recr. (3) and cr. (9) (a) and (b), Register, July, 1971, No. 187, eff. 8-1-71; am. (3) (a) and (b) and (9) (b), Register, August, 1971, No. 188, eff. 9-1-71; am. (1), (2) (b), and (9) (a), Register, August, 1972, No. 200, eff. 9-1-72; am. (9) (b), Register, August, 1973, No. 212, eff. 9-1-73; emerg. r. and recr. (9), Register, December, 1974, No. 228, eff. 1-1-75; am. (3) (a), Register, January, 1975, No. 229, eff. 2-1-75; am. (7) (a), Register, October, 1975, No. 238, eff. 11-1-75; cr. (10), Register, May, 1976, No. 245, eff. 8-15-76; renum. (1) to be (1) (a), cr. (1) (b), r. (3) (a) to (c), renum. (3) (d) to be (3) and am. (9), Register, November, 1976, No. 251, eff. 12-1-76; renum. (1) (b) to be (1) (c) and am., am. (3) and r. and recr. (10), Register, May, 1977, No. 257, eff. 6-1-77; am. (1) (a), Register, December, 1977, No. 264, eff. 1-1-78; r. and recr. (10), Register, May, 1978, No. 269, eff. 6-1-78, renum. (1) (c) to be 10.001 (8) and (9) am. (8), Register, August, 1978, No. 272, eff. 9-1-78; r. and recr. Register, August, 1979, No. 284, eff. 9-1-79; r. and recr. (1) (g), Register, April, 1980, No. 292, eff. 5-1-80; r. (1) (c), Register, April, 1981, No. 304, eff. 5-1-81; r. and recr. (1) (g) 2., Register, April, 1982, No. 316, eff. 5-1-82; cr. (1) (i), Register, October, 1987, No. 382, eff. 11-1-87; emerg. am. (2) (d), eff. 9-25-87; am. (2) (d), Register, December, 1987, No. 384, eff. 1-1-88.

Register, January, 1989, No. 397

**NR 10.08 Possession of game.** (1) **OPENING DAY LIMITS.** On the first day of the open season, no person may possess or control more than one daily bag limit of any game species for which a bag limit is established.

(2) **DAILY BAG.** No person may take more than one daily bag limit in any one day.

(3) **POSSESSION LIMIT.** No person may possess more than 2 daily bag limits unless otherwise authorized by the department.

(4) **FIELD POSSESSION LIMIT.** No person may possess more than one daily bag limit while at or between the place killed and the place to which the bag limit is taken.

**Note:** This rule does not authorize a person to take more than one daily bag limit. Further, it does not prohibit possession of double the daily bag limit when transporting game between a person's temporary abode and his or her permanent abode.

(5) **KILLING REQUIREMENTS.** Except as otherwise provided, no person may possess any live game. All game taken during the open season shall be killed immediately and made part of the daily bag.

**History:** 1-2-56; r. (2), Register, August, 1956, No. 8, eff. 9-1-56; r. and recr. (3), Register, August, 1968, No. 152, eff. 9-1-68; renum. to be NR 10.21; am. (3)(a) and (b), Register, June, 1970, No. 174, eff. 7-1-70; am. (3)(a), Register, August, 1973, No. 212, eff. 9-1-73; r. and recr. (3), Register, August, 1978, No. 272, eff. 9-1-78; renum. from NR 10.21, Register, September, 1983, No. 333, eff. 10-1-83; r. and recr. Register, September, 1985, No. 357, eff. 10-1-85.

**NR 10.09 Guns, ammunition and other devices.** (1) **PROHIBITED METHODS.** No person shall:

(a) *Shotshells.* 1. Slugs or balls. Possess or have in control, while hunting, any shotshells loaded with single slug or ball except during the open gun season for deer or bear.

2. Size. Possess or have in control while hunting, shells containing shot larger than no. BB June 1 through December 31, except during the open season established in s. NR 10.01 (1) (b), (c), and (g) when nontoxic shot size BBB and T may be used for hunting migratory game birds.

3. Game bird hunting. Hunt any game bird with a rifle or shotgun loaded with single ball or slug or shot larger than no. BB.

(b) *Incendiary shells.* Possess or have in control, while hunting, any shell, cartridge or ammunition known as tracer shells, or incendiary shells or cartridges. Distress flares are exempt from this section.

(c) *Guns and devices.* 1. Type. Hunt with any means other than the use of a gun discharged from the shoulder, bow and arrow or by falconry except:

a. Muzzle-loaders may be used for hunting as defined in s. NR 10.001 (17) and (18).

b. Hare, rabbit, squirrel, raccoon, fox, coyote, bobcat and unprotected wild animals may be hunted with .22 rim-fire handguns and pellet guns of .177 caliber or larger.

c. Deer may be hunted with handguns loaded with .357, .41 and .44 magnum caliber cartridges or any other caliber handgun chambered for commercially manufactured cartridges which produce a minimum muzzle energy of 1000 foot pounds. Such handguns shall have a minimum barrel length of 5½ inches measured from the muzzle to the firing pin with the action closed.

Note: Persons under the age of 18 years, pursuant to s. 941.22, Stats., may not hunt with handguns. Hunters using handguns must comply with all state and federal laws respecting handguns, including s. 941.23, Stats., respecting concealment, and s. 29.224, Stats., respecting transportation.

d. Crossbows may be used by disabled individuals issued a permit under s. 29.104 (4), Stats.

2. Deer or bear hunting. Hunt any deer or bear with any .22 rim-fire rifle, 5 mm rim-fire rifle, .17 caliber center-fire rifle or .410 bore shotgun.

3. Possession. Possess any rifle larger than .22 rim-fire in areas wherein there is an open season for hunting deer with shotguns only unless such rifle is unloaded and enclosed within a carrying case.

(2) SPECIAL ONE-DAY RESTRICTION. During the 24-hour period prior to the opening date for hunting deer with guns, no person shall possess a gun wherein there is an open season for deer with guns unless the gun is unloaded and enclosed within a carrying case. Exceptions:

(a) Target shooting at established ranges.

(b) Hunting on licensed game farms and shooting preserves.

(c) Hunting migratory game birds during the open season.

(3) BOWS AND ARROWS. No person may:

(b) *Special restrictions.* Use, possess or have under control while hunting, any poisoned or drugged arrow, arrow with explosive tips or any crossbow.

(c) *Arrow standards.* Use, possess or have under control while deer or bear hunting, any arrow with a metal broad-head blade less than seven-eighths of an inch in width. Such broad-head blades must be well-sharpened.

(d) *Bow size.* Hunt deer or bear with a bow having a pull of less than 30 pounds.

History: 1-2-56; am. (6), Register, August, 1956, No. 8, eff. 9-1-56; am. (3), (4), (5), (6), Register, August, 1957, No. 20, eff. 9-1-57; am (4) and (5), Register, August, 1958, No. 32, eff. 9-1-58; r. and recr. (4), (5), (6), and r. (7), Register, August, 1959, No. 44, eff. 9-1-59; am. (2), Register, August, 1960, No. 56, eff. 9-1-60; am. (2), Register, August, 1961, No. 68, eff. 9-1-61; r. (1); am. (3); r. and recr. (5), Register, August, 1963, No. 92, eff. 9-1-63; am. (3), Register, August, 1966, No. 128, eff. 9-1-66; renum. to be NR 10.09; am. (6), Register, June, 1970, No. 174, eff. 7-1-70; am. (4) and (5), Register, August, 1973, No. 212, eff. 9-1-73; am. (4), Register, August, 1975, No. 236, eff. 9-1-75; am. (6), Register, May, 1976, No. 245, eff. 8-15-76; r. and recr. (4), Register, May, 1978, No. 269, eff. 6-1-78; r. and recr., Register, August, 1979, No. 284, eff. 9-1-79; r. and recr. (1) (c), Register, April, 1982, No. 316, eff. 5-1-82; cr. (1) (c)2. and 3. and (3), Register, September, 1983, No. 333, eff. 10-1-83; am. (1) (a) 2. and (c) 1. a., Register, September, 1985, No. 357, eff. 10-1-85; emerg. r. and recr. (1) (a) 2., eff. 9-25-87; am. (1) (c) 1. c., Register, October, 1987, No. 382, eff. 1-1-88; r. and recr. (1) (a) 2., Register, December, 1987, No. 384, eff. 1-1-88; r. (3) (a), Register, October, 1988, No. 394, eff. 1-1-89.

**NR 10.10 Deer and bear hunting. (1) PROHIBITED METHODS.** No person shall hunt deer or bear by any of the following methods:

(b) *Dogs.* With the aid of dogs, except that dogs may be used for hunting bear during the season established in s. NR 10.01 (3) (g) 2. in that portion of the state north of the highways shown in the following map:

Register, January, 1989, No. 397

(a) *Hunter's choice deer hunting permit.* Valid for the taking of one deer of either sex or age, except on Chambers Island in Door County where the bag limit shall be one antlerless deer or one buck deer with a forked antler as indicated on the permit.

(b) *Antlerless deer hunting permit.* Valid for the taking of one antlerless deer only.

(7) **DEER HARVEST QUOTAS.** Deer harvest quotas are based on deer management unit populations in relation to established population goals as determined by inventories, the past effect of varying antlerless harvest levels on deer management unit populations, and the estimated impact of the previous winter's severity on deer survival and subsequent fawn production.

(a) *Purpose.* The department shall issue party permits, antlerless permits or hunter's choice permits in sufficient numbers to assure maintenance of overwintering deer populations for each deer management unit indicated in par. (d).

(b) *Permit formula.* In each deer management unit, the number of permits to be issued to harvest the desired number of deer shall be based on the hunter success rate average from the most recent 3 previous seasons or by an average of fewer seasons where a 3-year average is not available. In establishing a harvest quota for a deer management unit without an adequate history of permits, the average success rates of similar deer management unit shall be applied or the department shall estimate an anticipated success rate. The permit number formula is:

$$\text{Permit number} = \frac{\text{Antlerless deer to be harvested}}{\text{Hunter success rate}}$$

(c) *Success rate formula.* Permit success rates used to compute the number of permits to be issued for each deer management unit shall be those calculated by the department from annual deer season harvest statistics except where no previous history of success rates exist. The success rate formula is:

$$\text{Success rate} = \frac{\text{Number of antlerless deer harvested}}{\text{Number permits issued}}$$

(d) *Overwinter goals.* Overwinter population goals expressed in terms of deer per square mile of deer range by deer management unit are as follows:

## WISCONSIN ADMINISTRATIVE CODE

Management Unit	Deer Goal	Management Unit	Deer Goal
1	15	41	20
2	20	42	20
3	10	43	15
4	15	44	15
5	20	45	20
6	10	46	20
7	10	47	20
8	20	48	20
9	20	49	25
10	30	50	15
11	20	51	20
12	20	52	20
13	15	53	30
14	15	54A	30
15	25	54B	25
16	25	54C	25
17	15	55	25
18	20	56	30
19	20	57	15
20	20	57A	30
21	25	57B	25
22	20	57C	30
22A	20	58	25
23	20	59A	15
24	20	59B	15
25	25	59C	25
26	20	59D	15
27	15	60	20
28	10	60A	20
29A	15	61	20
29B	10	62A	30
30	15	62B	30
31	20	63A	30
32	20	63B	25
33	20	64	20
34	10	65A	30
35	15	65B	30
36	25	66	30
37	25	67	30
38	15	67A	35
39	15	67B	35
40	15	68	30



Management Unit	Deer Goal	Management Unit	Deer Goal
69	20	74B	15
70	25	75	15
70A	25	75A	15
70B	30	76	20
70E	30	76A	20
71	20	77A	20
72	20	77B	10
73	20	77C	15
73B	15	78	25
73C	20	80	15
74A	15	81	15

**History:** Cr. Register, October, 1957, No. 22, eff. 11-1-57; r. (1), (2) and (3) and recr. (1) and (2), Register, August, 1958, No. 32, eff. 9-1-58; am. (2), Register, August, 1959, No. 44, eff. 9-1-59; r. Register, August, 1962, No. 80, eff. 9-1-62; recr. Register, August, 1963, No. 92, eff. 9-1-63; am. (1), (2), (5) and (6), Register, August, 1964, No. 104, eff. 9-1-64; emergency rule cr. (7), eff. 10-17-64; am. (1), (5) and (6); cr. (7), Register, August, 1965, No. 116, eff. 9-1-65; am. (5) and (6), Register, August, 1966, No. 128, eff. 9-1-66; emerg. am. (5), eff. 9-1-67; am. (5) and (6) Register, August, 1968, No. 152, eff. 9-1-68; am. (1), (5) and (6), Register, August, 1969, No. 164, eff. 9-1-69; renum. to be NR 10.115, Register, June, 1970, No. 174, eff. 7-1-70; r. (5), and am. (7), Register, August, 1971, No. 188, eff. 9-1-71; cr. (5) and (8), r. and recr. (6) and (7), Register, November, 1976, No. 251, eff. 12-1-76; am. (6), Register, August, 1978, No. 272, eff. 9-1-78; r. and recr. (1), (2) and (4), Register, August, 1979, No. 284, eff. 9-1-79; r. (1), Register, August, 1980, No. 296, eff. 9-1-80; emerg. r. and recr. eff. 9-30-83; r. and recr., Register, October, 1983, No. 334, eff. 11-1-83; r. and recr. (2) to (6), Register, October, 1984, No. 346, eff. 11-1-84; am. (1), (3) (a) and (5), r. and recr. (3) (b) and (6), r. (3) (c), Register, September, 1985, No. 357, eff. 10-1-85; renum. from NR 10.115, Register, June, 1986, No. 366, eff. 7-1-86; r. and recr. (2) (c), Register, August, 1986, No. 368, eff. 9-1-86; cr. (7), Register, July, 1988, No. 391, eff. 8-1-88; cr. (2) (d), Register, July, 1989, No. 403, eff. 8-1-89.

**NR 10.105 Transportation of deer and bear.** (1) No person may transport any deer or bear in or on any motor-driven vehicle from the time such deer or bear is killed to the time it is lawfully registered pursuant to s. NR 10.106 unless the deer or bear is carried openly exposed and in such a manner so that the deer or bear carcass tag attached to the deer or bear cannot be handled or manipulated by any occupant of the vehicle.

(2) No person may transport a deer or bear from the time the deer or bear is killed to the time it is registered under s. NR 10.106 that is tagged with the carcass tag of another person unless accompanied by the person issued the carcass tag.

**History:** Cr. Register, August, 1960, No. 56, eff. 9-1-60; renum. to be NR 10.19, Register, June, 1970, No. 174, eff. 7-1-70; correction made under s. 13.93 (2m) (b) 7, Stats., renum. to be NR 10.103, Register, September, 1984, No. 345, eff. 10-1-84; renum. from NR 10.103 and am. Register, June, 1986, No. 366, eff. 7-1-86; renum. to be (1) and am., cr. (2), Register, October, 1988, No. 394, eff. 11-1-88.

**NR 10.106 Recording deer and bear.** (1) **CARCASS CONDITION AND TRANSPORTATION.** Deer and bear shall be intact except they may be field dressed. These animals or animal parts may not be removed from the area specified in this section unless exhibited, registered and tagged.

(2) **EXHIBITION AND REGISTRATION.** Each person who has killed a deer or if s. 29.405, Stats., applies, the person who has tagged the deer, during the open seasons for hunting deer with guns or bear during the open seasons for hunting bear with guns or bows shall exhibit and register the deer with the deer carcass tag attached as required by s. 29.40 (1), Stats., and s. NR 10.103, or the bear with the bear carcass tag attached as re-

Register, July, 1989, No. 403

quired by s. 29.1085 (5), Stats., and s. NR 10.101(4) at an authorized registration station as follows:

(a) *Gun license deer.* Gun license deer shall be registered within the open season zone in which the deer was killed no later than 5:00 p.m. of the first day following the season's close.

(b) *Special permit deer.* Party permit deer or antlerless deer taken under the authority of a hunter's choice permit shall be registered within the deer management unit in which the deer was killed no later than 5:00 p.m. of the first day following the season's close unless transported on federal or state highways directly to the authorized registration station in an adjoining deer management unit.

(c) *Lake Superior islands deer.* Any gun killed deer taken on any of the islands in the outlying waters of Lake Superior in Ashland and Bayfield counties shall be registered within the deer management unit in which the deer was killed or within the city of Bayfield no later than 5:00 p.m. of the first day following the close of such season.

(d) *Archer license deer.* Archer license deer shall be registered within the county in which the deer was killed unless transported on federal or state highways directly to an authorized registration station outside the county in which the deer was killed by 5:00 P.M. on the third day after the deer was killed.

(e) *Bear license (bow and gun).* Bear shall be registered within the county in which the bear was killed or adjoining county and within the black bear management zone in which it was killed no later than 5:00 p.m. of the day after it was killed.

(3) **REGISTRATION TAGGING.** (a) *Bear.* Upon verification of license information, the station operator shall lock a registration tag to the bear or bear part.

(b) *Deer.* For deer, the operator shall:

1. Complete and retain the registration portion of the hunter's license; and
2. Lock a registration tag to the deer or deer part.
3. Remove the validation portion of the carcass tag.

**Note:** The portion of the deer carcass tag remaining attached to the animal contains a number corresponding to the registrant's hunting license and backtag.

**History:** Cr. Register, June, 1986, No. 366, eff. 7-1-86; am. (2) (intro.), r. and recr. (2) (d), Register, July, 1989, No. 403, eff. 8-1-89.

**NR 10.117 Deer season modification.** (1) **POWERS.** The secretary of the department may, upon making the findings in sub. (2), extend the gun deer season for any deer management unit or any group of deer management units to reduce or maintain the deer population to the overwinter population goals established in s. NR 10.104 (7) (d).

(2) **FINDING.** The secretary shall, prior to exercising powers under sub. (1), find:

(a) It is unlikely the deer population for the deer management unit will be reduced to or maintained at the overwinter population goals established in s. NR 10.104 (7) (d) during the established gun deer season. A

DEPARTMENT OF NATURAL RESOURCES

130-1  
NR 10

minimum of 2 days of the gun deer season have been completed and the harvest data available has been reviewed and considered by the department;

Next page is numbered 131

3. Persons successful in obtaining a turkey permit and tag for any numbered zone are not eligible to receive a Ft. McCoy military reservation turkey hunting permit.

*Note:* Any person may apply for a state and Ft. McCoy wild turkey hunting permit simultaneously. The Ft. McCoy drawing of successful applicants will occur after successful state applicants are listed by the department. As a result, Ft. McCoy officials will be able to reject Ft. McCoy applicants appearing on the department list.

(2) **TAGGING PROCEDURE.** (a) *Carcass tag use.* In wild turkey hunting zones, when a wild turkey is killed and before it is carried by hand or transported in any manner, the hunter shall:

1. Validate the permit by tearing or cutting out notches on the carcass tag designating the day of kill. Failure to follow the validation procedure in this manner invalidates the permit.

2. Completely attach and seal the carcass tag, utilizing its own adhesive, around the leg of the turkey.

(b) *Transportation and possession.* No person may possess or transport a wild turkey taken in any wild turkey hunting zone established in s. NR 10.29 unless the person has lawfully killed and tagged it.

(3) **REGISTRATION.** A person who possesses a wild turkey killed in a wild turkey hunting zone shall exhibit and register the bird at a department station as follows:

(a) *Spring season.* A wild turkey taken during the season established in s. NR 10.01 (2) (f) 1. shall be registered no later than 1:30 p.m. on the day killed.

(b) *Fall season.* A wild turkey taken during the season established in s. NR 10.01 (2) (f) 3., shall be registered no later than 5:00 p.m. of the day after it was killed.

(4) **RESTRICTIONS.** No person may hunt wild turkeys:

(a) By any means other than a shotgun or muzzle-loading shotgun fired from the shoulder or a bow and arrow.

(b) With the aid of recorded bird calls or sounds or electrically amplified imitations of bird calls or sounds.

(c) With the aid of dogs.

(d) With live decoys for the purposes of enticing wild turkeys.

*History:* Cr. Register, March, 1966, No. 123, eff. 4-1-66; r. and recr. Register, March, 1967, No. 135, eff. 4-1-67; am. (3), (5) and (7)(a), Register, March, 1968, No. 147, eff. 4-1-68; renum. to be NR 10.25, Register, June, 1970, No. 174, eff. 7-1-70; r. and recr., Register, November, 1982, No. 323, eff. 12-1-82; am. (1) (c) 2. and (3), Register, March, 1985, No. 351, eff. 4-1-85; r. and recr. (1) (c), Register, August, 1986, No. 368, eff. 9-1-86; am. (1) (a), (2) (a) (intro.), (b) and (3), Register, July, 1988, No. 391, eff. 8-1-88; r. and recr. (1) (c) 2. and 3. and (3), cr. (1) (c) 4., Register, October, 1988, No. 394, eff. 1-1-89; am. (1) (a), r. and recr. (1) (c) (intro.), cr. (1) (e) 3., Register, March, 1989, No. 399, eff. 4-1-89.

**NR 10.27 State park deer hunting.** No person may hunt deer on state parks and recreation land except as provided in this section. Portions of the properties listed may be posted closed to deer hunting.

(1) **MUZZLE-LOADER SEASON;** Deer hunting by muzzle-loader is allowed in Blue Mound, Governor Dodge and Perrot state parks during the seasons specified in s. NR 10.01 (3) (e) 3.

(2) **FIREARM SEASON.** Deer hunting by firearm is allowed in Natural Bridge and Wyalusing state parks during the season specified in s. NR 10.01 (3) (e) 1. d.

(3) **EARLY BOW SEASON.** Deer hunting by bow and arrow through November is allowed in Buckhorn state park as specified in s. NR 10.01 (3) (em).

(4) **FIREARM AND BOW SEASONS.** Deer hunting by firearm and bow and arrow is allowed in the Plum Island part of Grand Traverse Islands state park during the seasons specified in s. NR 10.01 (3) (e) 1. d. and (em).

(5) **FIREARM AND LATE BOW SEASONS.** Deer hunting by firearm and bow and arrow is established by s. NR 10.01 (3) (e) 1. d and the December portion of s. NR 10.01 (3) (em) for the following:

- (a) Big Bay state park
- (b) Devil's Lake state park
- (c) Elroy-Sparta state trail
- (d) Hartman Creek state park
- (e) Interstate state park
- (f) Kinnickinnic state park
- (g) Mirror Lake state park
- (h) Newport state park
- (i) Rock Island state park
- (j) Tuscobia-Park Falls state trail
- (k) Wildcat Mountain state park
- (l) Willow River state park

**History:** Emerg. cr. eff. 10-11-68; cr. Register, August, 1969, No. 164, eff. 9-1-69; renum. to be NR 10.27; am. intro, par., Register, June, 1970, No. 174, eff. 7-1-70; am. (1) Register, August, 1972, No. 200, eff. 9-1-72; am. Register, November, 1972, No. 203, eff. 12-1-72; am. (2), Register, March, 1975, No. 231, eff. 4-1-75; emerg. renum (3) to be (4) and cr. (3) eff. 9-24-75; renum. (3) to be (4), cr. (4), Register, September, 1975, No. 237, eff. 10-1-75; am. (1) and (2), Register, November, 1976, No. 251, eff. 12-1-76; am. (2), Register, May, 1977, No. 257, eff. 6-1-77; am. (3), Register, August, 1978, No. 272, eff. 9-1-78; am. (1), Register, March, 1979, No. 279, eff. 4-1-79; am. (1) and (2), Register, August, 1981, No. 308, eff. 9-1-81; r. and recr. Register, July, 1985, No. 355, eff. 8-1-85; renum. (2) to (4) to be (3) to (5), cr. (2), Register, October, 1985, No. 358, eff. 11-1-85; r. and recr. Register, July, 1987, No. 379, eff. 8-1-87.

**NR 10.28 Deer management units.** Deer management units are established as designated on the following map:

**History:** Cr. Register, August, 1964, No. 104, eff. 9-1-64; am. map. Register, August, 1968, No. 152, eff. 9-1-68; r. and recr. Register, August, 1969, No. 164, eff. 9-1-69; renum. to be NR 10.24; am. (1), Register, June, 1970, No. 174, eff. 7-1-70; am. (1), and map Register, August, 1971, No. 188, eff. 9-1-71; am. (1), Register, September, 1972, No. 201, eff. 10-1-72; am. (1), Register, September, 1973, No. 213, eff. 10-1-73; am. (1), Register, May, 1976, No. 245, eff. 8-15-76; am. (1), Register, November, 1976, No. 251, eff. 12-1-76; am. Register, October, 1977, No. 262, eff. 11-1-77; renum. from NR 10.24 and am., Register, September, 1979, No. 285, eff. 10-1-79; r. and recr., Register, October, 1981, No. 310, eff. 11-1-81; emerg. am. eff. 9-9-82; r. and recr. Register, October, 1983, No. 334, eff. 11-1-83; r. and recr. Register, October, 1984, No. 346, eff. 11-1-84; r. and recr. Register, July, 1985, No. 355, eff. 8-1-85; r. and recr. October, 1985, No. 358, eff. 11-1-85; r. and recr. October, 1986, No. 370, eff. 11-1-86.

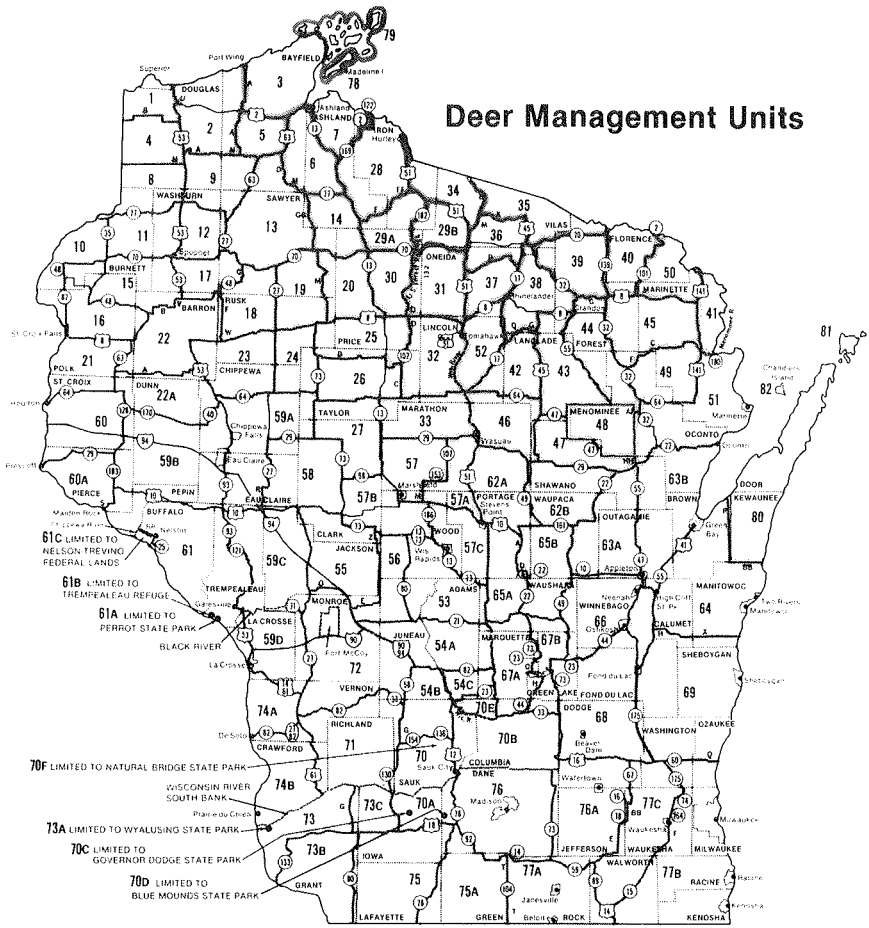

REV 7-86

**NR 10.29 Wild turkey hunting zones.** Wild turkey hunting zones are established as designated on the following map:

**History:** Cr. Register, November, 1982, No. 323, eff. 12-1-82; r. and recr. Register, March, 1984, No. 339, eff. 4-1-84; r. and recr. Register, March, 1985, No. 351, eff. 4-1-85; r. and recr. Register, October, 1985, No. 358, eff. 11-1-85; r. and recr., Register, October, 1987, No. 382, eff. 11-1-87; r. and recr. Register, January, 1988, No. 385, eff. 2-1-88; r. and recr. Register, March, 1989, No. 399, eff. 4-1-89.

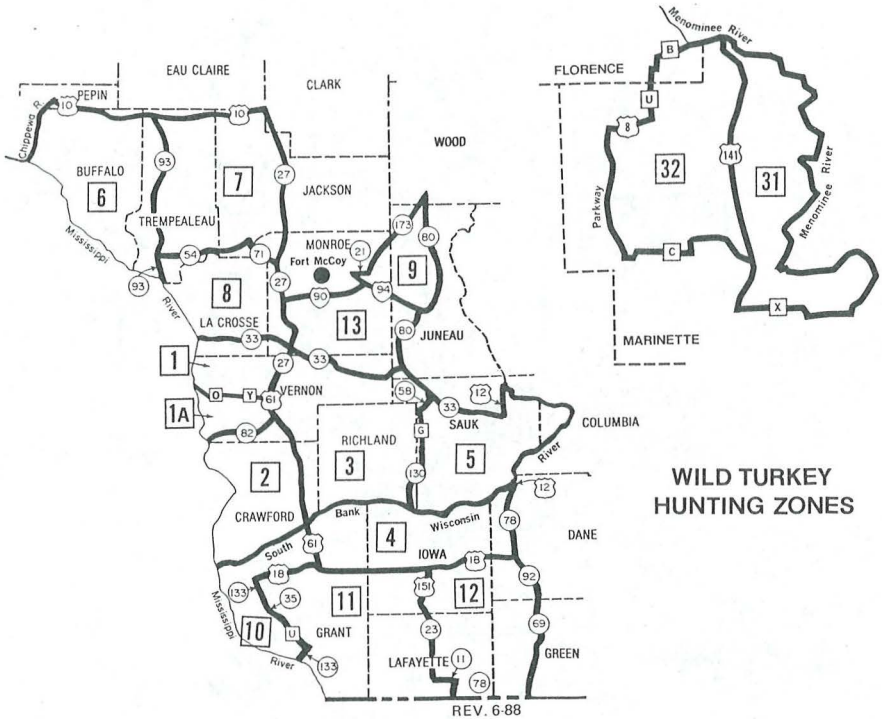

(7) NEW AUBURN ZONE.

*energy resource  
(1)(d)*

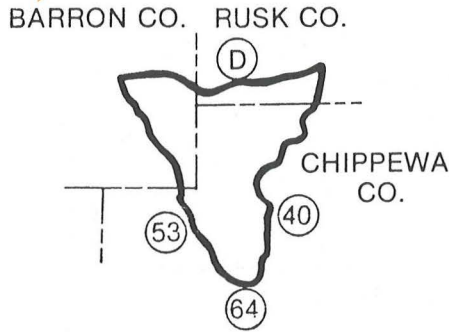

(8) PINE ISLAND ZONE.

*energy resource  
to (4)*

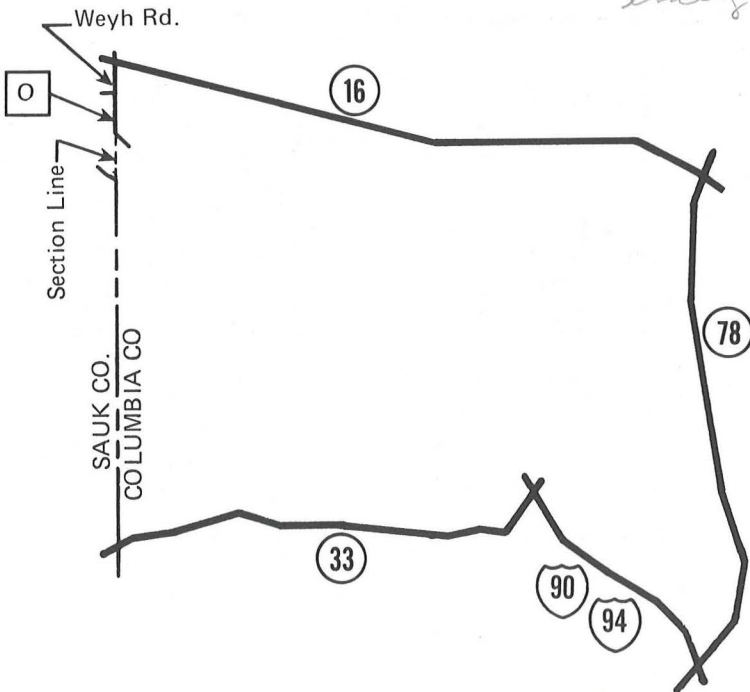



(9) ROCK PRAIRIE ZONE.

*emery  
re num.  
(1)(e)*

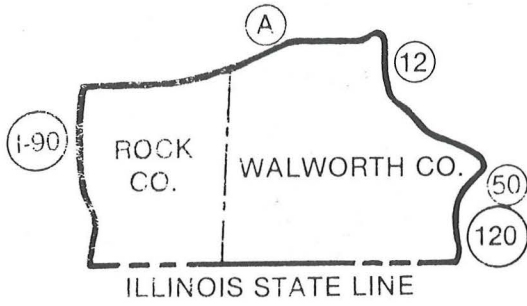

(10) THERESA ZONE.

*emery  
re num.  
(5)*

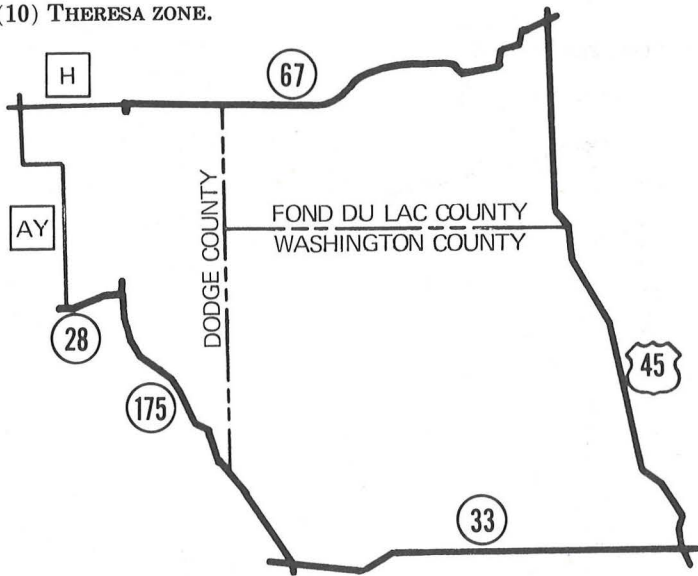

History: Cr. Register, July, 1988, No. 391, eff. 8-1-88.