

Kind of animal Locality	Open season (all dates inclusive)	Limit
2. Those portions of bear management zones A, B and C as described in s. NR 10.80 where the use of dogs for bear hunting is prohibited as described in s. NR 10.10(1)(b).	All methods not utilizing the aid of dogs, beginning on the second Saturday in September and continuing for 21 consecutive days in even-numbered years and beginning on the third Saturday in September for 21 days in odd-numbered years.	One adult bear per permit issued under s. NR 10.102.
(h) <i>Coyote</i>		
1. Hunting		
a. North of the highways established by subd. 3.	All year except closed during the gun season as established by s. NR 10.01 (3) (e) 1. d.	None
b. Remainder of the state	All year	None
2. Trapping		
a. North zone — All that part of Wisconsin north of state highway 64	Concurrent with the fox season established in s. NR 10.01 (3) (f) 1.	None
b. South zone — All that part of Wisconsin south of state highway 64	Concurrent with the fox season established in s. NR 10.01 (3) (f) 2.	None
3. Special closure — No person may hunt, shoot, shoot at, take, catch or pursue any coyote in that portion of the state north of the highways shown in the following map during the closed period described in subd. 1.		

Kind of animal Locality	Open season (all dates inclusive)	Limit
<b>(4) FURBEARING ANIMALS</b>		
<b>(a) Muskrat and mink trapping.</b>		
1. 'North zone' — All that part of Wisconsin north of state highway 64	Beginning on the Saturday nearest October 21 and continuing through December 31	None
2. 'Central zone' — All that part of Wisconsin south of state highway 64 and north of the line beginning at the junction of U.S. highway 18 with the western boundary of the state, then east along highway 18 to its junction with U.S. highway 51, then north along highway 51 to its junction with state highway 60, then east along highway 60 to its junction with Ozaukee county highway "Q" extended east to Lake Michigan except as described in subd. 3	Beginning on the Saturday nearest October 28 and continuing through December 31	None
3. 'Winnebago zone' — All that part of Dodge county lying north of state highway 60, Fond du Lac, Outagamie, Waupaca, Waushara and Winnebago counties	Beginning on the Saturday nearest October 28 and continuing through March 15	None
4. 'Mississippi River zone' — All that part of Buffalo, Crawford, Grant, LaCrosse, Trempealeau, and Vernon counties lying east of the Chippewa river and west of the Burlington Northern railway	Beginning on the day following the close of the open season for ducks as established under sub. (1) (b)1. and continuing through January 15	None
5. 'South zone' — All other parts of the state	Beginning on the Saturday nearest November 4 and continuing through December 31	None

**(b) Incidental take of muskrats.** During the closed season for muskrats, licensed trappers may retain for salvage any muskrats taken incidentally while trapping for beaver in the portions of the state open to beaver trapping as described in par. (c).

Kind of animal and locality	Open season (all dates inclusive)	Limit
<b>(c) Beaver trapping.</b>		
1. Zone A as described in s. NR 10.35.	Beginning on the Saturday nearest October 21 and continuing through March 15.	None
2. Zone B as described in s. NR 10.35.	Beginning on Saturday nearest October 21 and continuing through April 30.	None
3. Zone C as described in s. NR 10.35.	Dec. 1 - Mar. 15	None
4. Zone D as described in s. NR 10.35.	Beginning on the day following the close of the open season for ducks as established under sub. (1) (b) 1. and continuing through March 15.	None

9. e., Register September, 1985, No. 357, eff. 10-1-85; emerg. r. and recr. (1) (g) i. a., cr. (1) (g) i. am., eff. 10-19-85; r. and recr. (4) (a) 4., am. (2) (f), Register, January, 1986, No. 361, eff. 2-1-86, except (4) (a) 4., eff. 3-1-86; r. and recr. (1) (b), (g), (l) 2. b. and 5., (tm) 3., am. (1) (u) 1., Register, April, 1986, No. 364, eff. 6-1-86; r. and recr. (3) (g), Register, June, 1986, No. 366, eff. 7-1-86; am. (1) (l) 2. and 3. b., (3) (e) (Intro.) and (4) (e) 4., r. and recr. (3) (e) 2. and 6., (3) (em) and (4) (e) 1. b., r. (4) (d) 3. to 6., Register, August, 1986, No. 368, eff. 9-1-86; emerg. r. and recr. (1) (a), (b), (g), (l) 2. b. and 5., (tm) 3., and (u) 1., cr. (1) (e) 3. c., eff. 9-12-86; r. and recr. (3) (e) Intro. and 1. to 6., am. (3) (e) 9. e. and (4) (e) 2. Intro., Register, October, 1986, No. 370, eff. 11-1-86; r. and recr. (1) (a), (b), (g), (l) 2. b. and 5., (tm) 3., (u) 1., cr. (1) (l) 3. c., Register, January, 1987, No. 373, eff. 2-1-87; am. (2) (f) 1. and r. and recr. (2) (f) 2., Register, February, 1987, No. 374, eff. 3-1-87; cr. (4) (e) 8., Register, March, 1987, No. 375, eff. 4-1-87; r. (1) (q) and (r), r. and recr. (3) (g) and (4) (c), Register, July, No. 379, eff. 8-1-87; emerg. r. (1) (a), r. and recr. (1) (b), (c) 2., (g), (l) 2. b. and 5., (tm) 2., 3. and 4., (u) 1., eff. 9-25-87; am. (2) (f) 1. and 2., (3) (e) 9. e., r. and recr. (3) (h) 1. and (4) (e) 2., cr. (3) (h) 3., Register, October, 1987, No. 382, eff. 11-1-87; r. (1) (a), r. and recr. (1) (b), (c) 2., (g), (l) 2. b. and 5., (tm) 2. to 5., and (u) 1., Register, December, 1987, No. 384, eff. 1-1-88; r. and recr. (2) (f) 2., Register, January, 1988, No. 385, eff. 2-1-88; r. and recr. (4) (b), am. (4) (c), Register, June, 1988, No. 390, eff. 7-1-88; renum. (1) (h) to be NR 10.125 (6), r. (1) (l) to (tm), (3) (e) 7. and 9., am. (1) (u) 1., r. and recr. (2) (b) 2., Register, July, 1988, No. 391, eff. 8-1-88; emerg. cr. (1) (a), r. and recr. (1) (b), (c) and (g) eff. 9-21-88; am. (Intro.) and (2) (c) 1., Register, October, 1988, No. 394, eff. 11-1-88, cr. (2) (f) 3., Register, October, 1988, No. 394, eff. 1-1-89; cr. (1) (a), r. and recr. (1) (b), (c) and (g), Register, January, 1989, No. 397, eff. 2-1-89; r. and recr. (2) (f) 1. and 2., Register, March, 1989, No. 399, eff. 4-1-89; am. (3) (e) (Intro.), r. (4) (e) 1. d., Register, July, 1989, No. 403, eff. 8-1-89; am. (2) (b) 1., (3) (e) i. Intro. and a., 2. Intro., a. b., and e., r. and recr. (2) (d), (4) (dm) and (e) 2. d., renum. (3) (e) i. d. to be i. e., cr. (3) (e) 1. d., 2. l., 6. and 7., Register, October, 1989, No. 406, eff. 11-1-89; emerg. am. (1) (g) 1. a. and f., eff. 11-26-89; r. and recr. (2) (f) 1. and 2., Register, January, 1990, No. 409, eff. 2-1-90; r. and recr. (1) (b), (c) and (g), Register, March, 1990, No. 411, eff. 4-1-90; am. (4) (b) and (c), Register, May, 1990, No. 413, eff. 6-1-90; r. and recr. (2) (f) 2. and 3., cr. (1) (g) 1. m., Register, July, 1990, No. 415, eff. 8-1-90; am. (3) (f), Register, September, 1990, No. 417, eff. 10-1-90; r. and recr. (2) (a) and (c) 2., am. (3) (e) 2. Intro., a. and e., r. (3) (e) 6., renum. (3) (e) 7. to be 6., Register, October, 1990, No. 418, eff. 11-1-90; emerg. r. and recr. (3) (e) and (3) (h) 1. a., eff. 11-15-90; r. and recr. (2) (l) 2., Register, January, 1991, No. 421, eff. 2-1-91; r. and recr. (1) (b) and (g), Register, March, 1991, No. 423, eff. 4-1-91; and recr. (4) (c), Register, May, 1991, No. 425, eff. 6-1-91; r. and recr. (2) (f), Register, June, 1991, No. 426, eff. 7-1-91; r. and recr. (3) (em) and (g), Register, August, 1991, No. 428, eff. 9-1-91; r. and recr. (3) (h) 2., Register, September, 1991, No. 429, eff. 10-1-91.

Note: For a complete history of s. NR 10.01 from 1-2-56 through 11-30-73 see the history note following s. NR 10.01 published in November 1973, Register. For a complete history of s. NR 10.01 from 12-1-73 through 7-31-85 see the history note following s. NR 10.01 published in the July, 1985 Register.

**NR 10.02 Protected wild animals.** The following wild animals are designated protected. No person may take, attempt to take, transport or possess any protected wild animal at any time unless expressly authorized by the department.

- (1) Cougar, badger, moose, elk, wolverine and flying squirrel.
- (2) Endangered or threatened species listed in ch. NR 27.
- (3) White deer (monocolored).
- (4) Woodchuck except as provided in s. 29.24, Stats.
- (5) Prairie chicken, Canada spruce grouse (spruce hen), mourning doves, swans, cranes, bitterns, plovers, kingfishers, cormorants, herons, sandpipers and grebes.
- (6) Eagles, hawks, falcons, and owls except as provided in ch. NR 18.
- (7) Hen pheasants except as expressly provided in this chapter.
- (8) Any other wild bird not specified in this chapter.

History: 1-2-56; am. (2), Register, August, 1956, No. 8, eff. 9-1-56; am. (1), Register, August, 1957, No. 20, eff. 9-1-57; am. (1) and (2), Register, August, 1958, No. 32, eff. 9-1-58; am. (1) emerg. eff. 9-20-58; am. (1), Register, August, 1959, No. 44, eff. 9-1-59; am. (2), cr. (3), Register, September, 1965, No. 117, eff. 10-1-65; am. (2), Register, March, 1966, No. 123, eff. 4-1-66; am. (1), Register, August, 1967, No. 140, eff. 9-1-67; renum. to be NR 10.02; am. (2), Register, June, 1970, No. 174, eff. 7-1-70; am. (1), Register, September, 1972, No. 201, eff. 10-1-72; r. (3), Register, December, 1977, No. 264, eff. 1-1-78; r. and recr. Register, August, 1979, No. 284, eff. 9-1-79; am. (1), Register, September, 1983, No. 333, eff. 10-1-83; am. (1), Register, September, 1991, No. 429

Register, September, 1991, No. 429

ter, July, 1985, No. 355, eff. 8-1-85; cr. (intro.) Register, September, 1985, No. 357, eff. 10-1-85.

**NR 10.04 Unprotected wild animals.** The following wild animals are designated unprotected. No closed season, bag limit, size limit or possession limit applies to these animals.

- (1) Opossum, skunk and weasel.
- (2) Starlings, English sparrows, coturnix quail and chukar partridge.
- (3) Any other wild animal not specified in this chapter.

Note: Persons taking unprotected animals must possess a hunting or trapping license and comply with all method of taking requirements of this chapter unless otherwise authorized by the department in writing or exempted under ch. NR 12.

History: 1-2-56; am. (1) Register, August, 1957, No. 20, eff. 9-1-57; am. (2), Register, August, 1958, No. 32, eff. 9-1-58; renum. to be NR 10.04; am. (1) and (2), Register, June, 1970, No. 174, eff. 7-1-70; am. (1), Register, August, 1972, No. 200, eff. 9-1-72; r. and recr. Register, No. 251, eff. 12-1-76; r. and recr. Register, August, 1979, No. 284, eff. 9-1-79; am. (1), Register, October, 1980, No. 298, eff. 11-1-80; cr. (intro.), Register, September, 1985, No. 357, eff. 10-1-85.

**NR 10.05 Highways.** (1) **GENERAL HUNTING.** No person may hunt within 50 feet of a roadway's center except as provided in s. 167.31, Stats.

Note: The exceptions provided by s. 167.31, Stats., allows any person to legally hunting small game with a muzzle-loading firearm or shotgun loaded with shotshells containing shot size BB or smaller if the roadway is surfaced with anything other than concrete or blacktop.

(2) **WATERFOWL AND COOT HUNTING.** It shall be unlawful to hunt waterfowl or coot from any public roads or railroads including the respective rights-of-way along or within the area described as the Horicon zone in s. NR 10.31 (4).

History: 1-2-56; am. (1) and (2), Register, August, 1956, No. 8, eff. 9-1-56; am. (1) and (2), Register, August, 1957, No. 20, eff. 9-1-57; r. (1) and (2) and recr. (1), Register, August, 1958, No. 32, eff. 9-1-58; cr. (2), Register, September, 1960, No. 57, eff. 10-1-60; cr. (3), Register, August, 1963, No. 92, eff. 9-1-63; r. and recr. (2), Register, September, 1966, No. 129, eff. 10-1-66; emerg. am. (2), eff. 9-1-67; emerg. am. (2), eff. 9-30-68; emerg. am. (2), eff. 8-30-69; am. (2), Register, November, 1969, No. 167, eff. 12-1-69; renum. to be NR 10.05; cr. (4) and (5), Register, June, 1970, No. 174, eff. 7-1-70; emerg. am. (2), eff. 9-19-73; emerg. am. (2), eff. 9-24-75; am. (2), Register, May, 1976, No. 245, eff. 6-1-76; r. and recr. (1) am. (2) and r. (3), (4) and (5), Register, May, 1977, No. 257, eff. 6-1-77; am. (2), Register, February, 1978, No. 266, eff. 3-1-78; am. (1), Register, September, 1979, No. 285, eff. 10-1-79; am. (2), Register, July, 1989, No. 403, eff. 8-1-89.

**NR 10.06 Hunting hours.** (1) **GENERAL HUNTING.** All hunting hours, when specified in this chapter, mean Central Standard Time, and the daily opening (a.m.) and closing (p.m.) hours listed shall apply to the entire state.

(2) **HUNTING ZONES.** (a) *General.* General hunting hour zones are established as follows:

**Zone**

- A—all that part of the state lying east of 88°-00' longitude.
- B—all that part of the state lying between 88°-00' and 89°-00' long.
- C—all that part of the state lying between 89°-00' and 90°-00' long.
- D—all that part of the state lying between 90°-00' and 91°-00' long.
- E—all that part of the state lying between 91°-00' and 92°-00' long.
- F—all that part of the state lying west of 92°-00' longitude.

(b) *General prohibition.* Except as provided in subs. (4), (5), (6), (7) and (8), no person may hunt or shoot any game species on which an open season is prescribed on any day during the open season before the a.m. times or after the p.m. times established in sub. (3).

Register, September, 1991, No. 429

(4) MIGRATORY GAME BIRD HUNTING. Except as provided in pars. (a) to (c), the hunting hours for pursuing migratory game birds in Zone A are listed in the following table. The hunting hours for other zones are obtained by using the same procedure described for big and small game hunting in sub. (3) (a).

(a) All waterfowl hunting starts at noon on the first day of the duck hunting season established in s. NR 10.01 (1) (b).

(b) The hunting hours in the Theresa goose management zone close at 1:00 p.m. daily except on the first day of the duck hunting season established in s. NR 10.01 (1) (b) when the hunting hours close as shown in the table.

(c) Hunting hours for rails, snipe and woodcock, begin daily 30 minutes prior to the time listed for a.m. and end with the hours listed for p.m. in the table through November 12 after which the hunting hours are as listed in the table.

**Migratory Game Bird Hunting Hours C.S.T.**

DAY	September		October		November		December	
	A.M.	P.M.	A.M.	P.M.	A.M.	P.M.	A.M.	P.M.
1	5:16	6:27	5:48	5:33	6:26	4:44	6:33	4:18
2	5:17	6:25	5:50	5:32	6:27	4:43	6:34	4:18
3	5:18	6:23	5:51	5:30	6:28	4:42	6:35	4:18
4	5:19	6:22	5:52	5:28	6:29	4:40	6:36	4:18
5	5:20	6:20	5:53	5:26	6:31	4:39	6:37	4:17
6	5:21	6:18	5:54	5:25	6:32	4:38	6:38	4:17
7	5:22	6:16	5:55	5:23	6:33	4:37	6:39	4:17
8	5:23	6:15	5:56	5:21	6:35	4:36	6:40	4:17
9	5:24	6:13	5:58	5:20	6:36	4:35	6:41	4:17
10	5:25	6:11	5:59	5:18	6:37	4:33	6:42	4:17
11	5:26	6:09	6:00	5:16	6:38	4:32	6:42	4:17
12	5:28	6:08	6:01	5:15	6:40	4:31	6:43	4:17
13	5:29	6:06	6:02	5:13	6:11	4:30	6:44	4:17
14	5:30	6:04	6:03	5:11	6:12	4:29	6:45	4:18
15	5:31	6:02	6:05	5:10	6:14	4:28	6:46	4:18
16	5:32	6:00	6:06	5:08	6:15	4:28	6:46	4:18
17	5:33	5:59	6:07	5:06	6:16	4:27	6:47	4:18
18	5:34	5:57	6:08	5:05	6:17	4:26	6:48	4:19
19	5:35	5:55	6:09	5:03	6:19	4:25	6:48	4:19
20	5:36	5:53	6:11	5:02	6:20	4:24	6:49	4:19
21	5:37	5:51	6:12	5:00	6:21	4:24	6:49	4:20
22	5:38	5:50	6:13	4:58	6:22	4:23	6:50	4:20
23	5:40	5:48	6:14	4:57	6:23	4:22	6:50	4:21
24	5:41	5:46	6:16	4:55	6:25	4:22	6:51	4:22
25	5:42	5:44	6:17	4:54	6:26	4:21	6:51	4:22
26	5:43	5:42	6:18	4:53	6:27	4:20	6:52	4:23
27	5:44	5:41	6:19	4:51	6:28	4:20	6:52	4:24
28	5:45	5:39	6:21	4:50	6:29	4:19	6:52	4:24
29	5:46	5:37	6:22	4:48	6:30	4:19	6:52	4:25
30	5:47	5:35	6:23	4:47	6:32	4:19	6:53	4:26
31			6:24	4:46			6:53	4:27

Note: Times listed for Sept. 1 through Nov. 12 are sunrise and sunset and beginning on Nov. 13 and through Dec. 31, times listed are one half hour before sunrise and sunset.

(6) PHEASANT HUNTING. Pheasant hunting hours shall close at 2:00 p.m. daily within the posted boundaries of the following properties beginning the second day of the pheasant hunting season established in s. NR 10.01 (2) (c) and continuing for 13 consecutive days.

- (a) Allenton (Washington county)
- (b) Brooklyn (Dane and Green counties)
- (c) Collins (Manitowoc county)

NR 10

- (d) Dunnville (Dunn county)
- (e) Goose Lake (Dane county)
- (f) Holland (Brown county)
- (g) Horicon (Dodge county)
- (h) Killsnake (Calumet and Manitowoc counties)
- (i) Little Scarboro — Kewaunee (Kewaunee county)
- (j) Mazomanie (Dane county)
- (jm) Muddy Creek (Dunn county)
- (k) New Munster (Kenosha county)
- (l) Theresa (Dodge and Washington counties)
- (m) Tichigan (Racine county)
- (n) Vernon (Waukesha county)
- (o) White River (Green Lake and Marquette counties)
- (p) Witwen (Sauk county)

(7) **WILD TURKEY HUNTING.** The hunting hours for pursuing wild turkeys shall be the same as the hours established in sub. (3) except that spring hunting hours shall close at 12:00 noon daily.

(8) **EXCEPTIONS.** There are no hunting hour restrictions for pursuing coyote, fox, raccoon and all wild animals for which no closed season is established except as follows:

(a) *Bow bear and deer seasons.* Hunting hours established in sub. (3) shall apply to archers pursuing any species during the bow bear season established in s. NR 10.01 (3) (g) and during the bow deer season established in s. NR 10.01 (3) (em).

(b) *Gun deer season.* Hunting hours established in sub. (3) shall apply to bow and gun hunters pursuing any species during the regular gun deer season established in s. NR 10.01 (3) (e).

Note: The big game hunting hours do not apply to persons hunting coyote, fox, raccoon or other wild animals for which no closed season has been established during the muzzle-loader season or an extended gun deer season.

History: 1-2-56; am. (2); cr. (2m), Register, August, 1956, No. 8, eff. 9-1-56; am. (2m), Register, August, 1957, No. 20, eff. 9-1-57; am. (2), (2m) and (3), Register, August, 1958, No. 32, eff. 9-1-58; r. and recr. Register, August, 1959, No. 44, eff. 9-1-59, am. (2), cr. (2m) Register, Sept. 1959, No. 46, eff. 10-1-59; am. (2) and r. (2m), Register, September 1960, No. 57, eff. 10-1-60; am. (2), cr. (2m), Register, September, 1961, No. 69, eff. 10-1-61; r. and recr. (2) and (2m), Register, August, 1962, No. 80, eff. 9-1-62; r. and recr. Register, August, 1965, No. 116, eff. 9-1-65; am. (3), emerg. eff. 9-5-65; am. (2), Register, March, 1966, No. 123, eff. 4-1-66; r. and recr. Register, August, 1966, No. 128, eff. 9-1-66; r. cr. (2); cr. (4) Register, September, 1966, No. 129, eff. 10-1-66; r. and recr. (2) and (3), Register, August, 1967, No. 140, eff. 9-1-67; renum. to be NR 10.06; r. (4), Register, June, 1970, No. 174, eff. 7-1-70; am. (3), Register, August, 1971, No. 188, eff. 9-1-71; am. (3), Register, September, 1972, No. 201, eff. 10-1-72; am. (2), (3), Register, August, 1973, No. 212, eff. 9-1-73; am. (2), Register, September, 1973, No. 213, eff. 10-1-73; am. (3), Register, March, 1975, No. 231, eff. 4-1-75; emerg. am. (2) (d), eff. 9-24-75; am. (3), Register, October, 1975, No. 238, eff. 11-1-75; am. (2) (d) (eff. 6-1-76), am. (2) (c), Register, May, 1975, No. 245, eff. 8-15-76; am. (2) (d) and (3), Register, November, 1978, No. 251, eff. 12-1-76; am. (2) (a), Register, May, 1977, No. 257, eff. 6-1-77; r. and recr. (2) (d), Register, February, 1978, No. 266, eff. 3-1-78; am. (2) (c) and (e), Register, October, 1980, No. 298, eff. 11-1-80; am. (2) (c) and cr. (4) and (5), Register, November, 1982, No. 323, eff. 12-1-82; am. (2) (c) and cr. (6), Register, March, 1984, No. 339, eff. 4-1-84; am. (2) (d), Register, April 1985, No. 352, eff. 5-1-85; cr. (6) (jm), Register, October, 1985, No. 370, eff. 11-1-86; emerg. am. (2) (d), eff. 9-25-97; am. (2) (d), Register, December, 1987, No. 384, eff. 1-1-88; r. and recr. (2) (b), (3) to (5), r. (2) (d), renum. (2) (e) to be (3) (b), cr. (7) and Register, September, 1991, No. 429

(8), Register, October, 1988, No. 394, eff. 1-1-89; r. and recr. (4), Register, January 1989 No. 397 eff. 2-1-89; r. and recr. (2) (b), (3) (b), (7) and (8) (a) to (c), r. (2) (c) and (5), am. (3) (a), Register, October, 1989, No. 406, eff. 11-1-89; r. and recr. (4), Register, March, 1990, No. 411, eff. 4-1-90; am. (8) (b), Register, September, 1990, No. 417, eff. 10-1-90; am. (2) (b) and (3) (a), Register, August, 1991, No. 428, eff. 9-1-91; r. and recr. (4) (intro.), Register, September, 1991, No. 429, eff. 10-1-91.

**NR 10.07 General hunting. (1) PROHIBITED METHODS.** No person shall:

(a) *Aircraft.* Hunt with the aid of an airplane, including the use of an airplane to spot, rally or drive wild animals for hunters on the ground.

(b) *Devices.* 1. Place, operate or attend, spread, or set any net, pitfall, snare, spring gun, pivot gun, swivel gun, or other similar contrivance for the purpose of catching or which might catch, take or ensnare wild animals.

2. Use or possess any snare, trap or device designed or used for the purpose of driving rabbits out of their holes or dens.

(d) *Molesting.* Molest the nest or den of any squirrel.

(e) *Ferret.* Use or possess any ferret while hunting.

(f) *Retrieval.* Fail to make every reasonable effort to retrieve all wild animals killed or crippled; and until such effort is made, such wild animals shall be included in the daily bag.

(g) *Baiting.* 1. Place, use or hunt over bait contained within or containing metal, paper, plastic, glass, wood other than hollow stumps or other nondegradable materials.

2. Except as established in s. NR 10.12 (1) (h), use any bait material, liquid or scent for attracting wild animals containing honey, bones, fish, meat, solid animal fat or parts of animal carcasses.

3. Place or hunt over baiting material, liquid or scent within 50 yards of any trail, road or campsite used by the public.

4. Hunt over baiting material, liquid or scent during the archery season without possessing a valid, unused bear harvest permit or archery deer tag.

5. Use or hunt over a baited area containing more than 10 gallons of bait material or liquid scent.

6. This paragraph does not prohibit hunting over bait materials deposited by natural vegetation or found solely as a result of normal agricultural practices.

(i) *Dog use.* Hunt or pursue any free-roaming wild animal with the aid of dog or dogs May 1 to June 30 in that portion of the state north of the highways shown on the following map except for dog trials and training under permit as established by ch. NR 17:

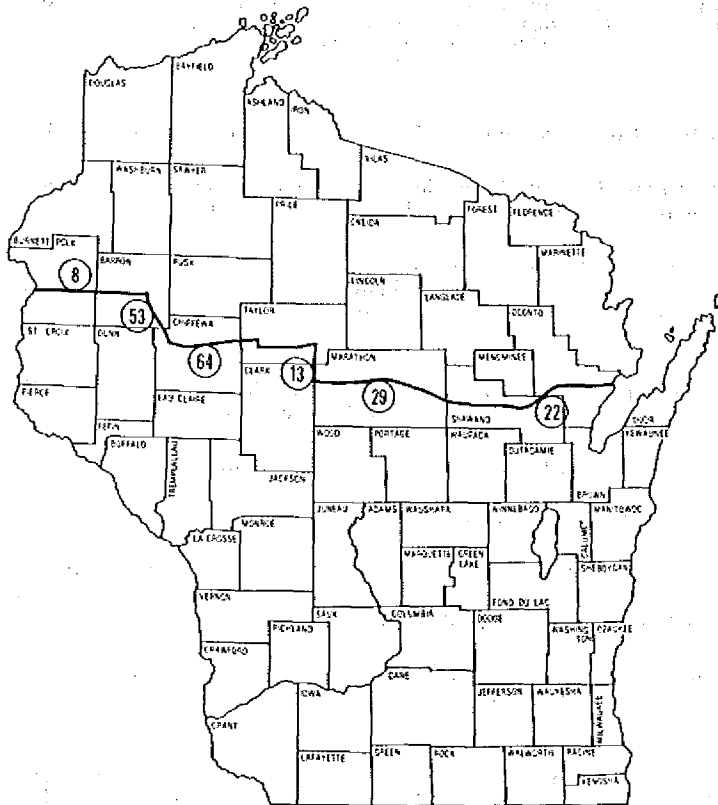

History: 1-2-56; am. (2), Register, August, 1957, No. 20, eff. 9-1-57; am. (5), Register, August, 1958, No. 32, eff. 9-1-58; r. and recr. (1) and (3), Register, August, 1960, No. 56, eff. 9-1-60; cr. (8), Register, September, 1961, No. 69, eff. 10-1-61; am. (1), Register, September, 1965, No. 117, eff. 10-1-65; r. (6), am. (7) (a), Register, August, 1966, No. 128, eff. 9-1-66; r. and recr. (2), Register, August, 1968, No. 152, eff. 9-1-68; renum. to be NR 10.07; am. (1), Register, June, 1970, No. 174, eff. 7-1-70; am. (2)(a), r. and recr. (3) and cr. (9)(a) and (b), Register, July, 1971, No. 187, eff. 8-1-71; am. (3)(a) and (b) and (9)(b), Register, August, 1971, No. 188, eff. 9-1-71; am. (1), (2)(b), and (9)(a), Register, August, 1972, No. 200, eff. 9-1-72; am. (9)(b), Register, August, 1973, No. 212, eff. 9-1-73; emerg. r. and recr. (9), eff. 8-2-74; r. and recr. (9), Register, December, 1974, No. 228, eff. 1-1-75; am. (3)(a), Register, January, 1975, No. 229, eff. 2-1-75; am. (7) (a), Register, October, 1975, No. 238, eff. 11-1-75; cr. (10), Register, May, 1976, No. 245, eff. 8-15-76; renum. (1) to be (1) (a), cr. (1) (b), r. (3) (a) to (c), renum. (3) (d) to be (3) and am. (9), Register, November, 1976, No. 251, eff. 12-1-76; renum. (1) (b) to be (1) (c) and am., am. (3) and r. and recr. (10), Register, May, 1977, No. 257, eff. 6-1-77; am. (1) (a), Register, December, 1977, No. 264, eff. 1-1-78; r. and recr. (10), Register, May, 1978, No. 269, eff. 6-1-78, renum. (1) (c) to be 10.001 (8) and (9) am. (8), Register, August, 1978, No. 272, eff. 9-1-78; r. and recr. Register, August, 1979, No. 284, eff. 9-1-79; r. and recr. (1) (g), Register, April, 1980, No. 292, eff. 5-1-80; r. (1) (c), Register, April, 1981, No. 304, eff. 5-1-81; r. and recr. (1) (g) 2., Register, April, 1982, No. 316, eff. 5-1-82; cr. (1) (i), Register, October, 1987, No. 382, eff. 11-1-87; emerg. am. (2) (d), eff. 9-25-87; am. (2) (d), Register, December, 1987, No. 384, eff. 1-1-88; r. and recr. (1) (g), r. (1) (h), Register, September, 1990, No. 417, eff. 10-1-90.

Register, September, 1991, No. 429



**NR 10.10 Deer and bear hunting. (1) PROHIBITED METHODS.** No person shall hunt deer or bear by any of the following methods:

(b) *Dogs.* With the aid of dogs, except that dogs may be used for hunting bear during the season established in s. NR 10.01 (3) (g) 2. in that portion of the state north of the highways shown in the following map:

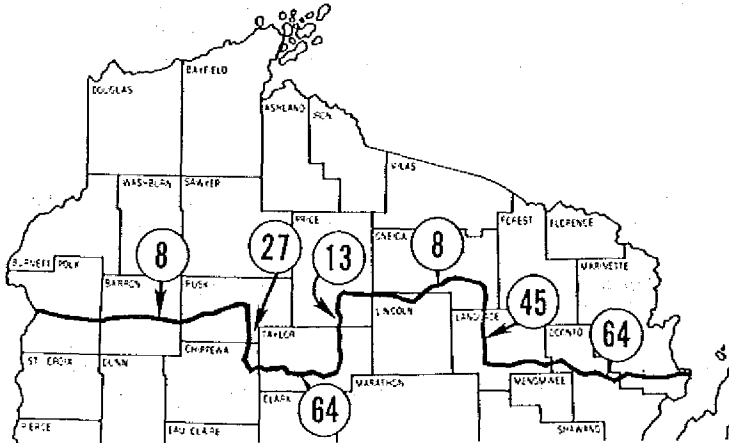

(2) **ILLEGAL GAME.** Any deer killed during the open season for hunting deer with bow and arrow showing evidence that it was shot with a firearm shall be an illegal game animal and no person may have such animal in possession.

History: 1-2-56; am. (2), Register, August, 1963, No. 92, eff. 9-1-63; am. (2), Register, August, 1966, No. 123, eff. 9-1-66; renum. to be NR 10.10, Register, June, 1970, No. 174, eff. 7-1-70; r. and recr. Register, August, 1972, No. 200, eff. 9-1-72; emerg. am. (2), and cr. (6) to (11), eff. 8-2-74; am. (2), cr. (6) to (11), Register, December, 1974, No. 223, eff. 1-1-76; am. (7) and r. (9), Register, May, 1976, No. 245, eff. 8-15-76; am. (1), (7) and (8), r. (5) and (6), Register, May, 1977, No. 257, eff. 6-1-77; r. and recr. Register, May, 1978, No. 269, eff. 6-1-78; r. (1) (a), Register, April, 1981, No. 304, eff. 5-1-81; (2) renum. from NR 10.11 (2), Register, September, 1983, No. 333, eff. 10-1-83; r. and recr. (1) (b), Register, September, 1984, No. 345, eff. 10-1-84; am. (2), Register, September, 1985, No. 357, eff. 10-1-85; am. (1) (b), Register, June, 1986, No. 366, eff. 7-1-86.

**NR 10.101 Bear hunting. (1) PROHIBITED METHODS.** No person may:

- (a) *Denned bear.* Hunt or shoot a bear in a den.
- (b) *Restricted areas.* Hunt bear in any dump or sanitary landfill.
- (c) *Adult bear with cubs.* Shoot, shoot at or kill an adult bear accompanied by a cub or cubs.

(2) **DOG USE RESTRICTIONS.** (a) *Identification.* No person shall hunt or pursue bear with any dog unless such dog is tattooed or wears a collar with the owner's name and address attached.

(b) *Training.* The training of dogs by pursuing wild bear is prohibited except July 1 through August 31.

Note: Bear dog trials and training are regulated by ch. NR 17.

Register, September, 1991, No. 429

(c) *Pack size.* No more than 6 dogs in a single pack may be used to pursue bear regardless of the number of bear hunters assisting the bear harvest permittee and regardless of the dog ownership.

Note: Only a bear hunting licensee with a bear harvest permittee may pursue bear during the open season on bear.

(d) *Dog replacement.* Until the maximum of 6 dogs are released in pursuit of a bear, dogs may be added to the pack. However, no dogs engaged in the pursuit of such bear may be replaced by another dog.

(e) *Bait use.* Persons hunting bear with dogs may use bait in accordance with s. NR 10.07 (1) (g) during the season established in s. NR 10.01 (3) (g) 2.

Note: This rule does not permit a person to hunt bear over bait without using dogs as a hunting aid.

(3) **BEAR CARCASS TAGS.** (a) *Validation.* Any person killing a bear shall immediately validate the carcass tag by slitting the mark designating the month, day, time of kill and bear sex.

(b) *Attachment.* Immediately following validation, the carcass tag shall be attached to the bear at any location on the bear.

(c) *Removal and retention.* A bear carcass tag attached under par. (b) and department registration tag may be removed from a gutted carcass at the time of butchering or when prepared by a licensed taxidermist, but the person who killed or obtained the bear shall retain all tags until the meat is consumed.

(d) *Exceptions.* Except as provided under par. (c) or s. 29.574 (6) (a) or (c), Stats., no person may possess, control, store or transport a bear carcass unless it is tagged as required under s. 29.1085 (5), Stats., and pars. (a) and (b).

History: Cr. Register, May, 1978, No. 269, eff. 6-1-78; cr. (1) (b)5., Register, August, 1979, No. 284, eff. 9-1-79; r. and recr. (1) (b) and (3) (b), Register, April, 1980, No. 292, eff. 5-1-80; am. (3) (b), Register, July, 1985, No. 355, eff. 8-1-85; am. (intro.), cr. (1) (c), (3) (e) and (4), r. and recr. (3) (c), Register, June, 1986, No. 366, eff. 7-1-86; am. (2) (c) 3., Register, July, 1987, No. 379, eff. 8-1-87; cr. (4) (d), Register, August, 1988, No. 392, eff. 9-1-88; am. (3) (b), Register, July, 1989, No. 403, eff. 8-1-89; r. (2), renum. (3) and (4) to be (2) and (3), Register, October, 1990, No. 418, eff. 11-1-90.

**NR 10.102 Bear hunting permits.** (1) **BEAR QUOTAS.** Bear quotas are based on the status of zone black bear populations in relation to established population goals as determined by inventories.

(a) *Purpose.* The department shall issue bear harvest permits in sufficient numbers to assure maintenance of bear populations for each zone indicated in par. (d).

(b) *Permit formula.* In each black bear management zone, the number of permits to be issued to harvest the desired numbers of bear shall be based on hunter success rates from previous seasons. In establishing permits for a zone without an adequate history of permits, the average success rates of similar zones shall be applied or the department shall estimate an anticipated success rate. The permit number formula is:

$$\text{Permit number} = \frac{\text{Bear to be harvested}}{\text{Hunter success rate}}$$

(c) *Success rate formula.* Permit success rates used to compute the number of permits to be issued for each zone shall be those calculated by the department from annual bear season harvest reports except where no previous history of success rates exist. The success rate formula is:

$$\text{Success rate} = \frac{\text{Number of bear harvested}}{\text{Number of permits issued}}$$

(d) *Population goals.* This fall, pre-hunt black bear population goal is as follows:

<u>Zone</u>	<u>Population Goal</u>
A	4,100
B	1,600
C	200

(2) **APPLICATION PROCEDURE.** Application for harvest permits shall be on forms provided by the department. Applicants shall indicate their black bear hunting zone preference. Applications shall be postmarked no later than the Friday nearest January 15 or received by the department license section, 101 South Webster, P.O. Box 7924, Madison, WI 53707 no later than 4:30 p.m. on that Friday each year.

(3) **PERMIT ISSUANCE.** The department shall select successful applicants and issue permit approval notices no later than February 15 of each year. The department may reissue a permit if the permit is returned undelivered by the postal authorities or if the applicant fails to or cannot comply with s. 29.1085, Stats. Selection shall be by random drawing.

(4) **FEES.** A successful applicant shall submit the appropriate permit fee established by s. 29.092 (2) (kg) or (kr), Stats., to the department before receiving a harvest permit. The fees shall be mailed and postmarked no later than the Friday nearest March 1 or received by the department license section, 101 South Webster, P.O. Box 7924, Madison, WI 53707 no later than 4:30 p.m. on that Friday each year.

(5) **PERMIT ATTACHMENT.** The bear harvest permit shall be attached to the bear hunting license by the applicant immediately upon receipt.

(6) **BEAR PURSUIT.** No licensee may pursue a bear by any method other than that person holds a valid bear harvest permit or is assisting a person who holds a valid bear harvest permit issued under s. 29.1085, Stats.

History: Cr. Register, June, 1986, No. 366, eff. 7-1-86; am. (1) (a) to (d), Register, July, 1987, No. 379, eff. 8-1-87; am. (1), Register, June, 1988, No. 390, eff. 7-1-88; r. and recr. (1) (a), renum. (1) (b) to (e) and (2) to be (2) to (6), Register, October, 1988, No. 394, eff. 1-1-89; am. (1) (b), Register, September, 1991, No. 429, eff. 10-1-91.

**NR 10.103 Deer hunting.** (1) **TAGS.** A one-piece back and carcass tag shall be issued with each hunting license and shall remain intact until the hunter kills a deer.

(2) **VALIDATION.** Any person who kills a deer shall immediately separate the issued carcass tag from the back tag and validate the carcass tag by slitting the mark designating the month, day, time of kill and type of deer. Failure to completely validate the carcass tag renders possession of the deer illegal and the carcass tag invalid.

Note: The carcass tag attachment procedures are also provided in s. 29.40 (2), Stats.

History: Cr. Register, Register, September, 1983, No. 333, eff. 10-1-83; r. and recr. Register, September, 1985, No. 357, eff. 10-1-85; renum. from NR 10.102, Register, June, 1986, No. 366, eff. 7-1-86.

**NR 10.104 Deer hunting permits.** (1) **FINDING.** The natural resources board finds that an additional harvest of deer is necessary to reduce the deer herd to the overwinter population goals established in s. NR 10.01 (3) (e) 9. e. and properly manage the deer herd in the state.

Register, September, 1991, No. 429

(2) **APPLICATION PROCEDURE.** Permits shall be in accordance with ss. 29.107 and 29.108, Stats., issued to any person in possession of a valid current Wisconsin deer hunting license applying in the following manner:

(a) *Limit.* No person may submit more than one application.

(b) *Form.* Application forms supplied by the department shall be completed and submitted by the applicant.

(c) *Application deadline.* Applications shall be postmarked no later than September 20 or received by the department license section, 101 South Webster, Box 7924, Madison, WI 53707, no later than 4:30 p.m. on that day each year.

(d) *Group applications.* Group applications up to and including 4 hunters will be honored for deer hunting established in s. NR 10.01 (3) (e) 3, provided each applicant completes the application form and all forms are submitted in one envelope marked "group application" on the outside.

(3) **PERMIT ISSUANCE.** Upon receipt of proper application, the department shall issue permits in the following manner:

(a) *Initial permit.* Successful applicants for hunter's choice or antlerless permits shall be determined by random selection from all eligible applications received for each deer management unit. Permits remaining unissued for any deer management unit after all initial applications have been processed may be issued by the department on a first-come, first-served basis, in accordance with any statutorily established landowner preference permit issuance system, or as established by par. (b).

(b) *Second permit.* If the number of hunter's choice or antlerless permits in any management unit exceeds the number of applications for such permits, the department may issue the remaining permits available for that unit as antlerless deer hunting permits only to its successful initial deer hunting permit applicants. Permittees to be issued the second permit shall be randomly selected in accordance with any statutorily established landowner preference permit issuance system.

(c) *Unallotted permits.* The department may issue any remaining antlerless deer permits as follows:

1. First step. Issue an additional antlerless permit to interested hunter's choice permit applicants; and may

2. Second step. Issue any remaining permits on a first-come, first-served basis to applicants who possess a valid gun deer hunting license and appear in person at designated department offices.

3. Antlerless permit limit. The department may not issue any applicant more than 2 antlerless deer permits in total.

(4) **PERMIT AUTHORITY.** No person may hunt antlerless deer in deer management units described as such in s. NR 10.01 (3) (e) unless he or she possesses a current validated deer hunting permit.

(5) **BAG LIMIT.** Each issued deer hunting permit shall authorize the use of the holder's current valid Wisconsin deer hunting license, back tag and

r. (5), and am. (7), Register, August, 1971, No. 188, eff. 9-1-71; cr. (5) and (8), r. and recr. (6) and (7), Register, November, 1976, No. 251, eff. 12-1-76; am. (6), Register, August, 1978, No. 272, eff. 9-1-78; r. and recr. (1), (2) and (4), Register, August, 1979, No. 284, eff. 9-1-79; r. (1), Register, August, 1980, No. 296, eff. 9-1-80; emerg. r. and recr. eff. 9-30-83; r. and recr., Register, October, 1983, No. 334, eff. 11-1-83; r. and recr. (2) to (6), Register, October, 1984, No. 346, eff. 11-1-84; am. (1), (3) (a) and (5), r. and recr. (3) (b) and (6), r. (3) (c), Register, September, 1985, No. 357, eff. 10-1-85; renum from NR 10.115, Register, June, 1986, No. 366, eff. 7-1-86; r. and recr. (2) (c), Register, August, 1986, No. 368, eff. 9-1-86; cr. (7), Register, July, 1988, No. 391, eff. 8-1-88; cr. (2) (d), Register, July, 1989, No. 403, eff. 8-1-89; am. (7) (d), Register, October, 1989, No. 406, eff. 11-1-89; r. and recr. (7) (b) and (c), Register, August, 1990, No. 416, eff. 9-1-90; am. (7) (d), Register, October, 1990, No. 418, eff. 11-1-90; r. and recr. (2) (d), Register, August, 1991, No. 428, eff. 9-1-91; am. (2) (c), r. (4), renum. (5) and (6) to be (4) and (5), Register, September, 1991, No. 429, eff. 10-1-91.

**NR 10.105 Transportation of deer and bear.** (1) No person may transport any deer or bear in or on any motor-driven vehicle from the time such deer or bear is killed to the time it is lawfully registered pursuant to s. NR 10.106 unless the deer or bear is carried openly exposed and in such a manner so that the deer or bear carcass tag attached to the deer or bear cannot be handled or manipulated by any occupant of the vehicle.

(2) No person may transport a deer or bear from the time the deer or bear is killed to the time it is registered under s. NR 10.106 that is tagged with the carcass tag of another person unless accompanied by the person issued the carcass tag.

History: Cr. Register, August, 1960, No. 56, eff. 9-1-60; renum. to be NR 10.19, Register, June, 1970, No. 174, eff. 7-1-70; correction made under s. 13.93 (2m) (b) 7, Stats., renum. to be NR 10.103, Register, September, 1984, No. 345, eff. 10-1-84; renum. from NR 10.103 and am. Register, June, 1986, No. 366, eff. 7-1-86; renum. to be (1) and am., cr. (2), Register, October, 1988, No. 394, eff. 11-1-88.

**NR 10.106 Recording deer and bear.** (1) **CARCASS CONDITION AND TRANSPORTATION.** Deer shall be intact except they may be field dressed. Bear may be skinned and quartered. These animals or animal parts may not be removed from the area specified in this section unless exhibited, registered and tagged.

(2) **EXHIBITION AND REGISTRATION.** Each person who has killed a deer or if s. 29.405, Stats., applies, the person who has tagged the deer, during the open seasons for hunting deer with guns or bear during the open seasons for hunting bear with guns or bows shall exhibit and register the deer with the deer carcass tag attached as required by s. 29.40 (1), Stats., and s. NR 10.103, or the bear with the bear carcass tag attached as required by s. 29.1085 (5), Stats., and s. NR 10.101(4) at an authorized registration station as follows:

(a) *Gun license deer.* Gun license deer shall be registered within the open season zone in which the deer was killed no later than 5:00 p.m. of the first day following the season's close.

(b) *Special permit deer.* Party permit deer or antlerless deer taken under the authority of a hunter's choice permit shall be registered within the deer management unit in which the deer was killed no later than 5:00 p.m. of the first day following the season's close unless transported on federal or state highways directly to the authorized registration station in an adjoining deer management unit.

(c) *Lake Superior islands deer.* Any gun killed deer taken on any of the islands in the outlying waters of Lake Superior in Ashland and Bayfield counties shall be registered within the deer management unit in which the deer was killed or within the city of Bayfield no later than 5:00 p.m. of the first day following the close of such season.

Register, September, 1991, No. 429

(d) *Bow killed deer.* 1. Time deadline. A deer killed under an archery deer license shall be registered no later than 5:00 P.M. on the third day after it was killed.

2. Registration station restrictions. Except as provided under subd. 3, bow killed deer may be registered at any department designated registration station.

3. Second deer restrictions. All persons authorized to kill a second antlerless deer shall register it within the deer management unit designated on the deer carcass tag.

(e) *Bear license (bow and gun).* Bear shall be registered within the county in which the bear was killed or adjoining county and within the black bear management zone in which it was killed no later than 5:00 p.m. of the day after it was killed.

(3) **REGISTRATION TAGGING.** Upon verification of license and deer hunting permit information, the station operator shall:

1. Complete and retain the registration portion of the hunter's license;
2. Lock a registration tag to the carcass or part of the deer or bear; and
3. Remove the validation portion of the carcass tag.

Note: The portion of the carcass tag remaining attached to the animal contains a number corresponding to the registrant's hunting license and backtag.

History: Cr. Register, June, 1986, No. 366, eff. 7-1-86; am. (2) (intro.), r. and recr. (2) (d), Register, July, 1989, No. 403, eff. 8-1-89; am. (1) and (2) (d), r. and recr. (3), Register, August, 1990, No. 416, eff. 9-1-90; r. and recr. (2) (d), Register, August, 1991, No. 428, eff. 9-1-91; am. (3) (intro.), Register, September, 1991, No. 429, eff. 10-1-91.

**NR 10.11 Bow deer season bag limit.** The department may authorize a 2 deer bag limit for licensed bowhunters in deer management units meeting the requirements of this section.

(1) **BOWHUNTER ELIGIBILITY.** Eligibility to harvest a second deer is restricted to those bowhunters that legally kill a deer in a deer management unit meeting the requirements of sub. (3) and register that deer at a registration station within a deer management unit designated under sub. (3) without transportation of the deer outside that management unit.

(2) **CONDITIONS OF AUTHORIZATION.** Authorization to harvest a second deer is limited to eligible bowhunters that apply for and receive a second deer carcass tag issued by the department. All persons authorized to harvest a second deer shall comply with the following conditions:

(a) *Type of deer.* Unless authorized by the department, only antlerless deer may be killed. The department shall authorize the harvest of a deer of either sex if the applicant's first deer was antlerless and was killed in a management unit designated under sub. (3).

(b) *Location.* All deer shall be killed within the deer management unit indicated on the permit, except that hunters authorized to take a deer of either sex may harvest a deer in any portion of the state. Hunters issued an antlerless tag may only hunt in the unit specified on the tag.

(3) **UNIT DESIGNATION.** The department may authorize a 2 deer bag limit in any deer management unit meeting the following conditions:

Register, September, 1991, No. 429

(a) *Population estimate.* The deer population estimate is at least 20% greater than the overwinter population goals established in s. NR 10.104 (7) (d); and

(b) *Bonus gun deer tags.* In units where hunter's choice permits are issued, all of the anticipated number of hunter's choice applicants will receive a hunter's choice permit. For purposes of determination, the department shall use the number of hunter's choice applications received in the previous year as the anticipated number of hunter's choice applications.

(4) APPLICATION PROCEDURE FOR SECOND CARCASS TAG. (a) *Limit.* No person may submit more than one application.

(b) *Forms and fees.* All applications shall be submitted complete on forms supplied by the department and be accompanied by payment of any statutorily established fees. All applications shall include the portion of first carcass tag that was detached by the deer registration station personnel.

(c) *Deadlines and locations.* Applications shall be mailed or delivered to any department office designated on the application form.

Note: Normal business hours are Monday through Friday from 7:45 A.M. to 4:30 P.M.

(5) ISSUANCE PROCEDURE. Upon receipt of a complete and valid application, the department shall designate the type of deer authorized for harvest and issue the applicant a second carcass tag and registration stub.

(6) PUBLIC NOTICE. The department shall provide public notice of any deer management units which meet the requirements of sub. (3) and to which this section applies by publication in the official state newspaper prior to July 1 of each year.

History: Cr. Register, August, 1991, No. 428, eff. 9-1-91.

NR 10.117 Deer season modification. (1) POWERS. The secretary of the department may, upon making the findings in sub. (2), extend the gun deer season for any deer management unit or any group of deer management units to reduce or maintain the deer population to the overwinter population goals established in s. NR 10.104 (7) (d).

(2) FINDING. The secretary shall, prior to exercising powers under sub. (1), find:

(a) It is unlikely the deer population for the deer management unit will be reduced to or maintained at the overwinter population goals established in s. NR 10.104 (7) (d) during the established gun deer season. A minimum of 2 days of the gun deer season have been completed and the harvest data available has been reviewed and considered by the department;

Next page is numbered 131

1. The first part of the document discusses the importance of maintaining accurate records of all transactions. This is essential for ensuring the integrity of the financial data and for facilitating the audit process.

2. The second part of the document outlines the various methods used to collect and analyze data. These methods include direct observation, interviews, and the use of statistical models to identify trends and patterns in the data.

3. The third part of the document describes the results of the data analysis. It shows that there is a significant correlation between the variables being studied, and that the data supports the hypothesis that was being tested.

4. The fourth part of the document discusses the implications of the findings. It suggests that the results of the study could be used to inform policy decisions and to guide future research in the field.

5. The fifth part of the document provides a conclusion and a list of references. The conclusion summarizes the main findings of the study, and the references list the sources of information used in the research.

6. The sixth part of the document contains a list of appendices. These appendices provide additional information that is relevant to the study, such as the raw data and the results of the statistical analyses.

7. The seventh part of the document is a list of figures and tables. These figures and tables provide a visual representation of the data and the results of the analysis.

8. The eighth part of the document is a list of footnotes. These footnotes provide additional information about the sources of the data and the methods used in the study.

9. The ninth part of the document is a list of acknowledgments. These acknowledgments thank the individuals and organizations that provided support and assistance during the course of the study.

10. The tenth part of the document is a list of references. These references list the sources of information used in the research.



ary, 1977, No. 253, eff. 2-1-77; r. and recr. Register, August, 1979, No. 284, eff. 9-1-79; am. (5) (a), Register, September, 1983, No. 333, eff. 10-1-83; cr. (6), Register, July, 1988, No. 391, eff. 8-1-88.

Note: For a complete history of NR 10.15 see the history note for NR 10.15 as it appeared in Register, August, 1978.

**NR 10.16 Necedah national wildlife refuge, Juneau county.** Except as provided in subs. (1), (2), (3), and (4) it shall be unlawful for any person to take, catch, kill, hunt, trap, or pursue any species of wild animal or bird at any time, or have in possession or under control any firearm unless the same is unloaded and enclosed within a carrying case, or any bow and arrow unless the same is unstrung or enclosed in a carrying case, upon that area known as the Necedah National Wildlife Refuge, Juneau county, Wisconsin. Nothing in this section shall prohibit, prevent, or interfere with the U.S. fish and wildlife service, its deputies, agents, or employes in the destruction of unprotected wild animals as listed in s. NR 10.04.

(1) **TRAPPING.** Within the discretion of the U.S. fish and wildlife service an open season for the taking of fur-bearing animals may be declared within the Necedah National Wildlife Refuge upon written approval of the department, which shall designate the species to be taken and establish opening and closing dates. Trapping on the Necedah National Wildlife Refuge shall be conducted under written permit from the U.S. fish and wildlife service. Such permit shall be subject to all the rules and regulations governing trapping set forth in this chapter.

(2) **BOW SEASON.** An open season for hunting deer, and unprotected wild animals as listed in s. NR 10.04, with bow and arrow shall be established on the Necedah National Wildlife Refuge and said season shall be concurrent with the state-wide season for bow and arrow established in s. NR 10.01 (3) (e). Such open season shall be effective only in those areas on the Necedah National Wildlife Refuge designated by posted notices of the U.S. fish and wildlife service. No special permits shall be required, but hunting licenses and deer tag as required by statutes are necessary.

(3) **FIREARM SEASON.** An open season for hunting deer, and unprotected wild animals as listed in s. NR 10.04, with firearms shall be established on the Necedah National Wildlife Refuge and such season shall fall within the season established for the remainder of Juneau county in s. NR 10.01 (3) (e). Such open season shall be effective only on those areas on the Necedah National Wildlife Refuge designated by posted notice of the U.S. fish and wildlife service. No special permits shall be required, but hunting licenses and deer tag as required by statutes under s. NR 10.01 (3) (e) shall apply.

(4) **TURKEY SEASON.** An open season for hunting wild turkeys as listed in s. NR 10.01 (2) (f) is established on the Necedah National Wildlife Refuge, and such season shall be concurrent with the open season for hunting turkeys as described in s. NR 10.01 (2) (f). Such open season shall be effective only in those areas on the Necedah National Wildlife Refuge designated by posted notices of the U.S. fish and wildlife service. Hunting on the Necedah National Wildlife Refuge shall be restricted to only those persons holding a valid principal or guest turkey hunting permit issued by the department.

History: 1-2-56, am. (1) and (2), Register, August, 1956, No. 8, eff. 9-1-56; am. intro. par., (1) and (2), Register, August, 1957, No. 20, eff. 9-1-57; r. intro. par., (1) and (2), and recr. intro. par., (1) and (2), and cr. (3), Register, August, 1958, No. 32, eff. 9-1-58; am. (3), Regis-

Register, September, 1991, No. 429

ter, September, 1959, No. 45, eff. 10-1-59; r. and recr., Register, August, 1962, No. 80, eff. 9-1-62; am. intro. par. and cr. (4), Register, March, 1967, No. 136, eff. 4-1-67; renum. to be NR 10.16, Register, June, 1970, No. 174, eff. 7-1-70; am. (4), Register, October, 1975, No. 238, eff. 11-1-75; am. Register, May, 1976, No. 245, eff. 8-16-76.

**NR 10.22 Sandhill wildlife demonstration area, Wood county.** (1) **PROHIBITED METHODS.** It shall be unlawful for any person to take, catch, kill, hunt, trap or pursue any species of wild animal or bird at any time, or have in possession or under control any firearm unless the same is unloaded and enclosed within a carrying case or any bow and arrow unless the same is unstrung or enclosed in a carrying case upon that area known as the Sandhill wildlife demonstration area in Wood county, Wisconsin, except as provided in this section.

(2) **SANDHILL OUTDOOR SKILLS CENTER.** (a) *Purpose.* The primary purpose of the Sandhill outdoor skills center is to teach wildlife-related outdoor skills. Wildlife-related outdoor skills are those relating to fishing, hunting, viewing, tracking, trapping, photography, management, study and conservation of wildlife.

(b) *Demonstration area use.* The department may limit use of the Sandhill wildlife demonstration area to persons participating in outdoor skills training programs.

(c) *Training authorization.* Subject to state law and federal regulations, the department may modify or waive hunting, trapping and property use rules respecting participants in a Sandhill outdoor skills training program. The modification or waiver shall be writing delivered to each participant upon a finding that it is necessary to achieve the objectives of the training program and consistent with the purpose in par. (a).

(d) *Program participation limits.* The department may limit the number of participants and establish application deadlines and prerequisites for programs at the Sandhill outdoor skills center. The department shall publish any applicable participation limits and program prerequisites as a part of any training program application forms or program guides developed by the department.

(e) *Application procedures.* Applications to participate in any Sandhill outdoor skills center program shall be on forms supplied by the department. No person may submit more than one application per program. All applications shall be mailed or delivered to: Sandhill Outdoor Skills Center, Box 156, Babcock, WI 54413.

(f) *Participant selection.* If the number of qualified applicants exceeds the program participation limit, the department may select program participants using either a first-come, first-served or random selection process.

(g) *Fees.* The department may charge program participants fees equivalent to the costs of providing the program training. All fees shall be paid in advance of program participation.

(3) **HUNTING.** (a) *Permit restrictions.* No person may hunt on the demonstration area without first obtaining a permit issued by the department. Permits shall be issued without charge.

1. *Effective dates.* Permits are valid only for the date of issue and shall be returned to the established check-out station immediately upon termination of hunting.

2. **Compartment limits.** All hunting is restricted to the type of game and compartment designated on the permit.

3. **Quotas.** Daily hunting permits shall be limited by the department based upon environmental conditions and annual research objectives.

4. **Exhibition required.** All harvested game shall be exhibited at the established check-out station as described on the permit.

5. **Limitations.** Permits issued to an individual are not transferrable and may not be altered or defaced.

6. **Reports.** Permit holders may be required to provide hunt information on department forms at the established check-out station.

(b) *Permit application procedures.* Any person possessing a valid Wisconsin hunting license may apply for a hunting permit.

1. **Forms.** Application shall be made on department forms.

2. **Issuance period.** Daily permits may be issued by the department at established check-in stations on a first-come, first-served basis or by random selection of mailed applications. Mailed applications are subject to the following restrictions:

a. No person may submit more than one application. Submission of more than one application shall disqualify the application permit eligibility.

b. Group applications up to and including 4 hunters will be honored provided each applicant completes the application form and all forms are submitted in one envelope marked "group application" on the outside.

3. **Self-completed permits.** Applications for hunting any game species except deer shall be completed by the applicant in person the day of the hunt. The self-completed permit portion of the application shall be retained by the applicant until the hunt is completed.

4. **University of Wisconsin research.** Permits may be issued to the university of Wisconsin for research purposes under a cooperative agreement with the department.

5. **Waiting procedure.** Hunters waiting to apply for permits shall form a single line. Each vehicle in line may contain no more than 5 applicants and shall be occupied at all times by all persons applying for permits that day.

(c) *Season and bag limits.* The hunting season and bag limits for all game species are established in s. NR 10.01 and may continue no longer than the Sunday immediately prior to the deer season established in subd. 2. with the following exceptions:

1. **Rabbits and hares.** Snowshoe hare and cottontail rabbit hunting shall open on the Saturday nearest September 15.

2. **Deer.** Deer hunting shall be established at the discretion of the department and continue until the annual harvest objective is obtained. The sex and type of legal deer shall be established by permit.

3. Extended seasons. The seasons for any game species may be resumed at the discretion of the department and continue through December 31.

(d) *Hunting hours.* The hunting hours for all species shall be the hours established in s. NR 10.06.

(e) *Information.* Information on the availability of hunting and trapping permits, permit application procedures, species which may be taken and other applicable conditions of taking on the demonstration area for each calendar year, except for extended seasons, shall be made available by the department at the demonstration area, district and Madison offices no later than August 1 of that year. Information relating to extended seasons shall be made available in the same manner prior to the extended season opening.

(4) **TRAPPING.** (a) *Permits.* Trapping will be allowed by permit only and may be issued on a seasonal basis dependent upon furbearer population levels.

(b) *Annual assessment.* Each year the department shall determine:

1. The number of permits to be issued.
2. The number of animals to be harvested.
3. The time when such trapping may take place.
4. The deadline date for receipt of applications.

5. Such additional restrictions as are necessary to preserve, protect and utilize the furbearing resources on this area.

(c) *Permit selection procedure.* If applications for permits exceed the number of permits available, random selection shall be used to determine successful applicants.

*History:* Cr. Register, September, 1962, No. 81, eff. 10-1-62; r. and recr. Register, August, 1963, No. 92, eff. 9-1-63; r. and recr. (2), Register, August, 1964, No. 104, eff. 9-1-64; am. (2)(a), Register, August, 1965, No. 116, eff. 9-1-65; am. (2)(a), Register, August, 1966, No. 128, eff. 9-1-66; am. (2)(a), Register, August, 1967, No. 140, eff. 9-1-67; r. and recr. (2) (intro. par.) and (a), Register, August, 1968, No. 152, eff. 9-1-68; r. and recr. (2), Register, August, 1969, No. 164, eff. 9-1-69; renum. to be NR 10.22; r. and recr. (2) intro. par. and (a); cr. (2)(h), Register, June, 1970, No. 174, eff. 7-1-70; am. (1) and (2), Register, July, 1971, No. 187, eff. 8-1-71; r. and recr.; Register, August, 1972, No. 200, eff. 9-1-72; am. Register, August, 1973, No. 212, eff. 9-1-73; am. (2)(b), Register, March, 1975, No. 231, eff. 3-1-75; am. (b) and (c), Register, May, 1977, No. 257, eff. 6-1-77; r. and recr. (2)(a), (b) and (c), Register, July, 1977, No. 259, eff. 8-1-77; cr. (3), Register, May, 1978, No. 269, eff. 6-1-78; am. (2)(b) 3.a., Register, October, 1978, No. 274, eff. 11-1-78; am. (2) (b) (intro.), 1. and 2. and (2) (c), r. and recr. (2) (b) 3., Register, September, 1979, No. 285, eff. 10-1-79; r. and recr. (2) (b) 1. and 2., am. (2) (b) 3. a. and (2) (c), Register, October, 1980, No. 298, eff. 11-1-80; r. and recr. (2) (b) 3.e., Register, October, 1981, No. 310, eff. 11-1-81; am. (2) (a), (b) 3.a. and b., Register, September, 1982, No. 321, eff. 10-1-82; am. (2) (a) and (2) (b) 3.b., r. and recr. (2) (b) 3.a., cr. (2) (i), Register, October, 1983, No. 334, eff. 11-1-83; r. and recr. (2), Register, September, 1984, No. 345, eff. 10-1-84; am. (2) (a) 2., r. (2) (c) 3., renum. (2) (c) 4. to be 3., Register, August, 1986, No. 368, eff. 9-1-86; renum. (2) and (3) to be (3) and (4), cr. (2), Register, September, 1991, No. 429, eff. 10-1-91.

**NR 10.23 Grand river experimental hunting area.** (1) **DESCRIPTION.** The area described in s. NR 11.27(11) and (12), shall be called the Grand River experimental hunting area.

(2) **RESTRICTIONS.** (a) It shall be unlawful for any person to take, catch, kill, hunt, trap or pursue any species of wild animal or bird at any time, or have in possession or under control any firearm unless it is un-

Register, September, 1991, No. 429

loaded and enclosed within a carrying case or any bow unless it is unstrung or enclosed in a carrying case upon that area known as the Grand River experimental hunting area except as provided in this section.

(b) Hunting in the Grand River experimental hunting area shall be from blinds as may be located on the area by the department. The department may further limit the number of blinds to be occupied each day.

(3) PERMIT AND TAG REQUIREMENT. In order to hunt Canada geese pursuant to this section, the applicant must comply with NR 10.01 (1) (1) and possess a special goose blind permit issued by the department.

(a) A goose blind application shall be completed and submitted by the applicant on a 3" X 5" post card bearing the name, address and current year hunting license number of each applicant.

(b) Applications must be received by the department no later than September 10 of each year.

(c) No more than 2 persons may apply on a single application card.

(d) It shall be unlawful for any person to submit more than one application per year or an application containing false information.

(4) REGISTRATION. (a) Each permit issued shall be validated by the department registration station located on the area prior to occupying any blind.

(b) Registration station hours shall begin one hour before the start of hunting hours. Hunters shall report to such station immediately after the close of hunting hours each day as established in sub. (6).

(c) All blinds will be assigned by one-half hour prior to shooting hours. Permittees numbered 1-20 who do not report prior to this time period shall be assigned blinds as they become available on a first-come, first-served basis.

(d) The department shall assign blinds by random selection at the registration station.

(e) Permits shall be returned to the registration station immediately upon completion of the permittee's hunt and all Canada geese bagged shall be presented for registration.

(5) GOOSE BLIND PERMIT RESTRICTIONS. (a) Goose blind permits shall be valid for a single, specified date and entitle each permittee to the daily bag limit of Canada geese.

(b) No more than 2 persons shall hunt from any blind.

(c) It shall be unlawful to hunt from any blind except those assigned to the hunter by the department.

(d) Goose blind permits are not transferable or replaceable and shall not be reused, altered or defaced.

(e) Permits and numbers assigned to such permits shall be issued on a random basis with priority of use as follows:

1. Thirty permits shall be issued for each day.

2. Permits numbered 1-20 shall be validated first each day pursuant to sub. (4).

3. Permits numbered 21-30 shall be validated as blinds become available.

(6) SEASON AND HUNTING HOURS. (a) The open season for hunting Canada geese shall begin October 2 and continue through November 16.

(b) The commencement of the daily hunting hours shall conform to those in s. NR 10.06 except that hunting hours shall terminate at noon each day unless otherwise indicated by signs posted at the registration station.

(7) Dogs are not permitted on the experimental hunting area described in sub. (1).

History: Cr. Register, December, 1978, No. 276, eff. 1-1-79

NR 10.24 Bong state recreation area hunting zone. (1) DESCRIPTION. The area described in s. NR 45.13 (18) (a) 1., shall be called the hunting zone.

(2) RESTRICTIONS. (a) *General prohibition.* No person may take, catch, kill, hunt, trap or pursue any species of wild animal at any time, or have in possession or under control any firearm unless it is unloaded and enclosed within a carrying case or any bow unless it is unstrung or enclosed within a carrying case in the hunting zone except as provided in this section.

(b) *Firearms.* All rifles and pistols, except starter pistols loaded with blanks, are prohibited except when they are transported unloaded and enclosed within a carrying case in a vehicle or automobile.

(c) *Other hunting methods.* Methods of hunting other than by use of rifles and pistols shall comply with those established in this chapter.

(3) PERMIT AND TAGS. (a) *General prohibition.* No person may hunt or trap within the hunting zone without first obtaining a permit issued by the department.

(b) *Limitations.* Permits and associated carcass tags are not transferable or replaceable and are valid only for the date and area specified on the permit.

(c) Daily hunting permits shall be issued as follows:

1. During the first 14 days of the pheasant season, the number of daily hunting permits issued to individuals may not exceed 300.

2. Beginning with the 15th day of the pheasant season, the number of daily hunting permits issued to individuals may not exceed 300 until 10:00 a.m. After 10:00 a.m., additional hunting permits may be issued on a first-come, first-served basis.

3. During the pheasant season, a maximum of 250 permits may be reserved for pheasant hunting.

(d) *Waterfowl.* Until the pheasant season opens, no more than 16 waterfowl permits may be issued each day for the area north of state highway 142.

Register, September, 1991, No. 429

(e) *Trapping.* The number of seasonal trapping permits may not exceed 10.

(f) *Legal game.* Permits are only valid for hunting or trapping the species specified on the permit.

(g) *Disposal.* Permits and unused carcass tags shall be returned to a department check-out station immediately upon termination of hunting.

(4) **RESERVATIONS.** (a) *Application period.* Hunting and trapping permit reservations may be obtained by applying on department forms between August 1 and August 31 each year.

(b) *Application limit.* No one may submit more than one application for a single date.

(c) *Random selection.* If the number of applications exceeds the number of permits available, a random drawing shall select successful applicants.

(d) *Application after deadline.* Applications received after August 31 shall be approved on a first-come, first-served basis if permits are available. Applications may be made in person, by mail or by telephone a minimum of 2 days prior to the desired hunting date.

(e) *Reservation limit.* No person may receive more than 5 waterfowl and 5 pheasant hunting reservations per season.

(f) *Check-in deadline.* Any person who obtains a hunting permit reservation and arrives at the department's check-in station after the opening of hunting hours shall forfeit such reservation. Any person with a waterfowl hunting permit reservation shall report at the department's check-in station no later than one-half hour before the opening of hunting hours or forfeit the reservation. Any person may obtain a daily permit on a first-come, first-served basis provided a permit is available.

(g) *Other standards.* All hunting permits are reservable and nontransferable.

(5) **HUNTER IDENTIFICATION.** Armbands or other means of identification issued with permits shall be worn on the outermost garment at all times and shall be returned to a department check-out station immediately upon termination of hunting.

(6) **SEASON AND HOURS.** (a) *General restrictions.* The open season and limits for hunting and trapping are established in s. NR 10.01, except the pheasant limits which shall be:

1. Daily bag—one, either sex for the first 14 days; 2, either sex, thereafter.

2. Possession—one the first day and double the daily bag limit thereafter.

(b) *Waterfowl and deer hours.* The daily opening of hunting hours for waterfowl and deer are established in s. NR 10.06.

(c) *Pheasant season exception.* The daily opening of hunting hours shall be in accordance with ss. NR 10.01 and 10.06 except during the pheasant season. During the pheasant season the daily opening of hunting hours shall be as follows:

1. Waterfowl and deer hunting shall be in accordance with ss. NR 10.01 and 10.06.

2. Pheasant hunting and all other species except waterfowl and deer hunting:

a. The Saturday nearest October 17—in accordance with ss. NR 10.01 and 10.06.

b. The Sunday nearest October 17 and running for 13 consecutive days—9:00 a.m.

c. Beginning with the 15th day of the pheasant season and thereafter in accordance with ss. NR 10.01 and 10.06.

(d) *Special closure.* The daily closing of hunting hours for all species is established in s. NR 10.06 except during pheasant season when all hunting shall end at 2:00 p.m. after the Saturday nearest October 17.

(e) *Trapping hours.* Trapping hours shall be the hours established in s. NR 10.13 (3).

(7) PHEASANT HUNTING. (a) *Tagging.* When a pheasant is killed and before it is carried by hand or transported in any manner, the hunter shall completely attach to the bird's leg a carcass tag issued by the department.

(b) *Tag retention.* The carcass tag shall remain attached to the pheasant until it is prepared for consumption.

(8) WATERFOWL HUNTING SOUTH OF STATE HIGHWAY 142. (a) *Blind requirement.* Hunting shall be restricted to blinds constructed, located and assigned by the department except for retrieval of crippled waterfowl.

(b) *Blind limitation.* No more than 2 persons may hunt from any blind.

(9) TRAPPING. (a) *Permit duration.* Trapping permits are valid for the entire season.

(b) *Other limitations.* Areas shall be determined by the department and no more than one permittee or helper may trap in any one area.

*History:* Cr. Register, August, 1981, No. 308, eff. 9-1-81; r. and recr. (3) (c), (4) (g) and (6) (a) and (b), am. (3) (g), (4) (a), (d), (e) and (f), renum. (6) (c) to (6) (e), cr. (6) (e) and (d), Register, August, 1984, No. 344, eff. 9-1-84; am. (3) (c) 2. and (6) (c) 2.b., r. (6) (c) 3., Register, June, 1987, No. 378, eff. 7-1-87; am. (4) (f), Register, July, 1989, No. 403, eff. 8-1-89; am. (1), Register, September, 1991, No. 429, eff. 10-1-91.

NR 10.25 Wild turkey hunting. (1) TAGS AND PERMITS. (a) *Permit requirement.* Except for turkey hunting outside of established zones during the open season for hunting wild turkeys, no person may hunt wild turkey unless they have first applied for and received a valid wild turkey hunting permit and tag from the department or Ft. McCoy military reservation.

(b) *Permit preference.* Qualified Wisconsin resident landowners or persons assigned eligibility under s. 29.103 (3) (b), Stats., may request first preference when applying for a wild turkey permit provided the zone applied for:

1. Is open to wild turkey hunting.

Register, September, 1991, No. 429



2. Contains at least 50 acres in one parcel owned by the Wisconsin resident applicant.

(c) *Permit application procedures.* Persons applying for wild turkey hunting permits on the Ft. McCoy military reservation apply to that facility for turkey hunting permits. All other applicants may apply for a turkey hunting permit as follows:

1. Application shall be made on forms provided by the department.

2. All spring hunting applications shall be postmarked no later than December 10 or received by the department license section, no later than 4:30 p.m. on that day to be considered for the spring turkey hunting season established in s. NR 10.01 (2) (f) 1.

3. All fall hunting applications shall be postmarked no later than August 10 or received by the department license section no later than 4:30 p.m. on that day to be considered for the fall turkey hunting season established in s. NR 10.01 (2) (f) 3.

Note: The License section address is 101 South Webster, Box 7924, Madison, WI 53707.

4. If a maximum of 2 persons wish to hunt together, each must complete an application form for individual permits and submit them together in a single envelope clearly marked "group application". Such group application shall be treated as one application for purposes of random selection or consideration for a permit. Preference may be requested by group applicants provided both individuals are eligible under par. (b).

(d) *Random selection.* If the number of applications for permits exceed the available number of permits as determined under this section, successful applicants shall be determined by random selection.

(e) *Permit and tag restrictions.* 1. Permit and carcass tags issued under this section are only valid for the zone and time period indicated on the permit.

2. Permits or carcass tags issued under this section may not be transferred to or used by any person other than the permittee.

3. Persons successful in obtaining a turkey permit and tag for any numbered zone are not eligible to receive a Ft. McCoy military reservation turkey hunting permit.

Note: Any person may apply for a state and Ft. McCoy wild turkey hunting permit simultaneously. The Ft. McCoy drawing of successful applicants will occur after successful state applicants are listed by the department. As a result, Ft. McCoy officials will be able to reject Ft. McCoy applicants appearing on the department list.

(2) TAGGING PROCEDURE. (a) *Carcass tag use.* In wild turkey hunting zones, when a wild turkey is killed and before it is carried by hand or transported in any manner, the hunter shall:

1. Validate the permit by tearing or cutting out notches on the carcass tag designating the day of kill. Failure to follow the validation procedure in this manner invalidates the permit.

2. Completely attach and seal the carcass tag, utilizing its own adhesive, around the leg of the turkey.

(b) *Transportation and possession.* No person may possess or transport a wild turkey taken in any wild turkey hunting zone established in s. NR 10.29 unless the person has lawfully killed and tagged it.

(3) **REGISTRATION.** A person who possesses a wild turkey killed in a wild turkey hunting zone shall exhibit and register the bird at a department station as follows:

(a) *Spring season.* A wild turkey taken during the season established in s. NR 10.01 (2) (f) 1. shall be registered no later than 1:30 p.m. on the day killed.

(b) *Fall season.* A wild turkey taken during the season established in s. NR 10.01 (2) (f) 3., shall be registered no later than 5:00 p.m. of the day after it was killed.

(4) **RESTRICTIONS.** No person may hunt wild turkeys:

(a) By any means other than a shotgun or muzzle-loading shotgun fired from the shoulder or a bow and arrow.

(b) With the aid of recorded bird calls or sounds or electrically amplified imitations of bird calls or sounds.

(c) With the aid of dogs.

(d) With live decoys for the purposes of enticing wild turkeys.

(e) With the aid of bait.

(5) **PERMIT QUOTA.** The number of wild turkey hunting permits issued annually for the spring and fall seasons shall be determined by the department. The department shall base its determination for each wild turkey hunting zone upon:

(a) The abundance and distribution of wild turkeys;

(b) Trends in hunter success rates;

(c) Hunter distribution and density; and

(d) Zone size and forested acreage.

*History:* Cr. Register, March, 1966, No. 123, eff. 4-1-66; r. and recr. Register, March, 1967, No. 135, eff. 4-1-67; am. (3), (5) and (7)(a), Register, March, 1968, No. 147, eff. 4-1-68; renun. to be NR 10.25, Register, June, 1970, No. 174, eff. 7-1-70; r. and recr., Register, November, 1982, No. 323, eff. 12-1-82; am. (1) (c) 2. and (3), Register, March, 1985, No. 351, eff. 4-1-85; r. and recr. (1) (c), Register, August, 1986, No. 368, eff. 9-1-86; am. (1) (a), (2) (a) (intro.), (b) and (3), Register, July, 1988, No. 391, eff. 8-1-88; r. and recr. (1) (c) 2. and 3. and (3), cr. (1) (c) 4., Register, October, 1988, No. 394, eff. 1-1-89; am. (1) (a), r. and recr. (1) (c) (intro.), cr. (1) (e) 3., Register, March, 1989, No. 399, eff. 4-1-89; cr. (4) (e), Register, July, 1990, No. 415, eff. 8-1-90; am. (1) (c) 2. and 3., Register, January, 1991, No. 421, eff. 2-1-91; cr. (5) Register, June, 1991, No. 426, eff. 7-1-91; am. (1) (c) (intro.), Register, September, 1991, No. 429, eff. 10-1-91.

**NR 10.27 State park deer hunting.** No person may hunt deer on state parks and recreation land except as provided in this section. Portions of the properties listed may be posted closed to deer hunting.

(1) **MUZZLE-LOADER SEASON;** Deer hunting by muzzle-loader is allowed in Blue Mound, Governor Dodge and Perrot state parks during the seasons specified in s. NR 10.01 (3) (e) 3.

Register, September, 1991, No. 429

(2) FIREARM SEASON. Deer hunting by firearm is allowed in Natural Bridge and Wyalusing state parks during the season specified in s. NR 10.01 (3) (e) 1. d.

(3) EARLY BOW SEASON. Deer hunting by bow and arrow through November is allowed in Buckhorn state park as specified in s. NR 10.01 (3) (em).

(4) FIREARM AND BOW SEASONS. Deer hunting by firearm and bow and arrow is allowed in the Plum Island part of Grand Traverse Islands state park during the seasons specified in s. NR 10.01 (3) (e) 1. d. and (em).

(5) FIREARM AND LATE BOW SEASONS. Deer hunting by firearm and bow and arrow is established by s. NR 10.01 (3) (e) 1. d and the December portion of s. NR 10.01 (3) (em) for the following:

- (a) Big Bay state park
- (b) Devil's Lake state park
- (c) Elroy-Sparta state trail
- (d) Hartman Creek state park
- (e) Interstate state park
- (f) Kinnickinnic state park
- (g) Mirror Lake state park
- (h) Newport state park
- (i) Rock Island state park
- (j) Tuscobia-Park Falls state trail
- (k) Wildcat Mountain state park
- (l) Willow River state park

History: Emerg. cr. eff. 10-11-68; cr. Register, August, 1969, No. 164, eff. 9-1-69; renum. to be NR 10.27; am. intro. par., Register, June, 1970, No. 174, eff. 7-1-70; am. (1) Register, August, 1972, No. 200, eff. 9-1-72; am. Register, November, 1972, No. 203, eff. 12-1-72; am. (2), Register, March, 1975, No. 231, eff. 4-1-75; emerg. renum (3) to be (4) and cr. (3) eff. 9-24-75; renum. (3) to be (4), cr. (4), Register, September, 1975, No. 237, eff. 10-1-75; am. (1) and (2), Register, November, 1976, No. 251, eff. 12-1-76; am. (2), Register, May, 1977, No. 257, eff. 6-1-77; am. (3), Register, August, 1978, No. 272, eff. 9-1-78; am. (1), Register, March, 1979, No. 279, eff. 4-1-79; am. (1) and (2), Register, August, 1981, No. 308, eff. 9-1-81; r. and recr. Register, July, 1985, No. 355, eff. 8-1-85; renum. (2) to (4) to be (3) to (5), cr. (2),

Register, September, 1991, No. 429

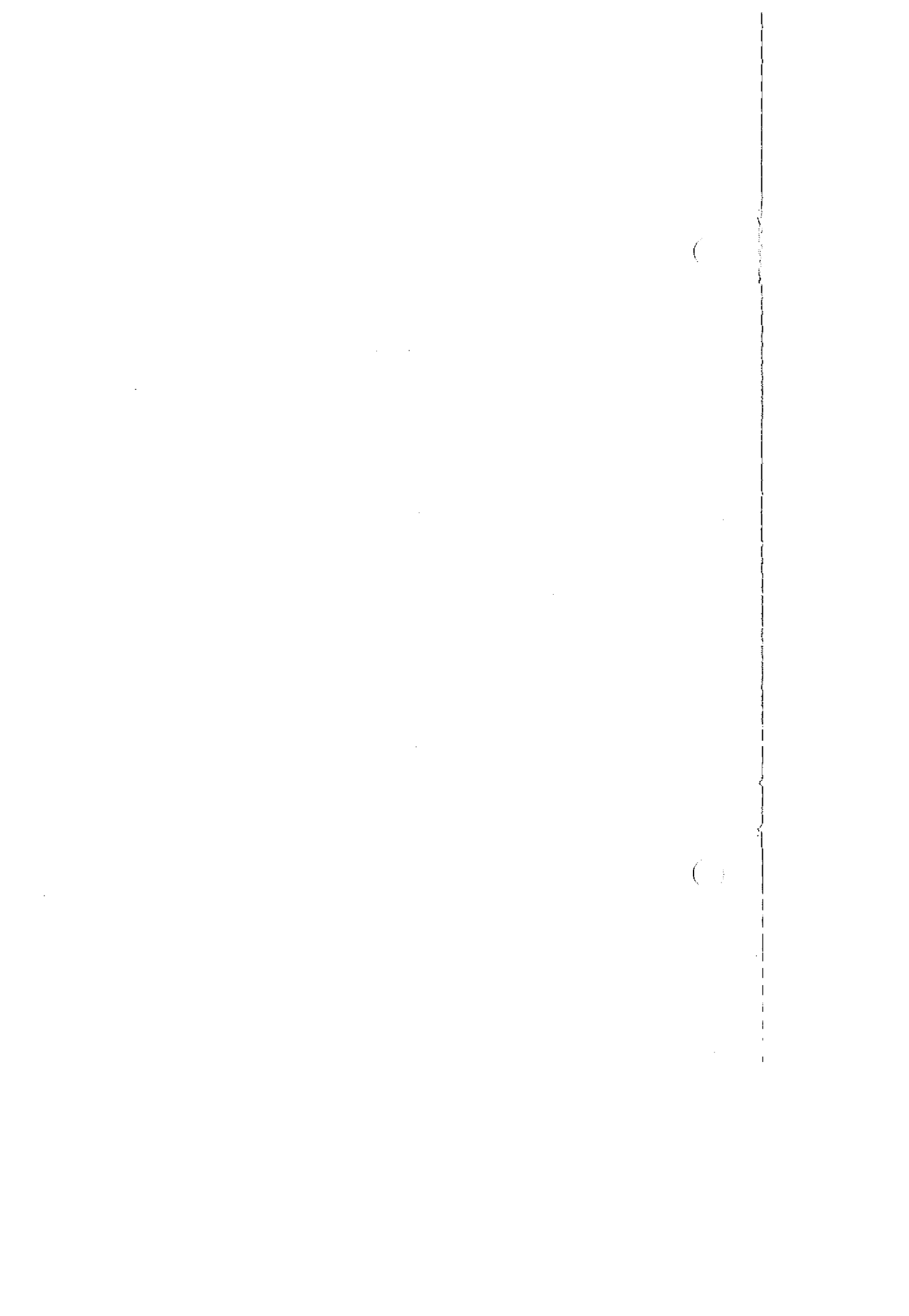

(2) COLLINS ZONE.

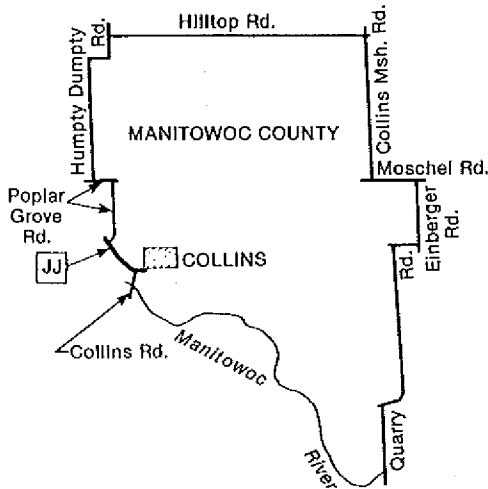

(3) HORICON ZONE. The Horicon goose management zone is defined in s. NR 10.001 (9m) and includes one subzone.

(a) Horizon zone boundaries.

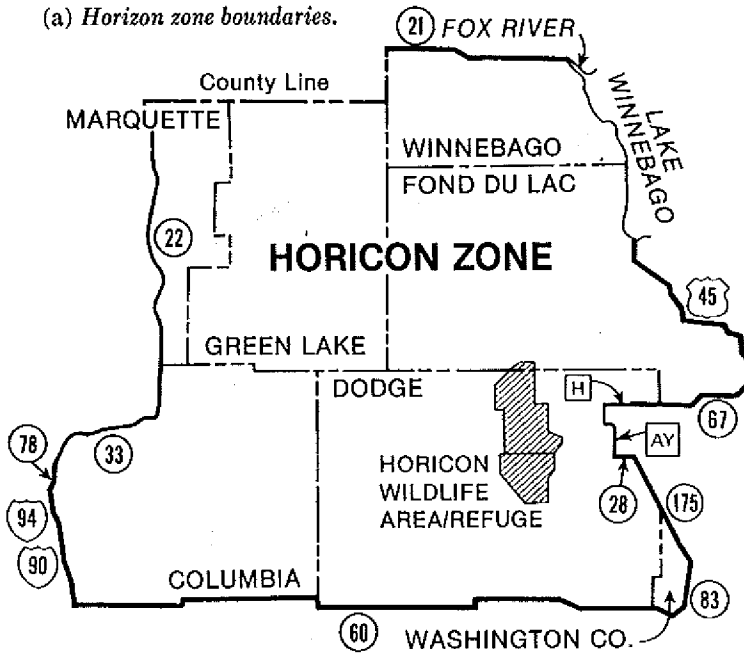

(b) *Horicon intensive management subzone.*

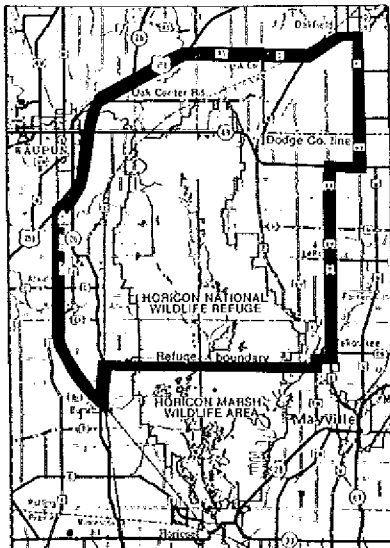

(4) PINE ISLAND ZONE.

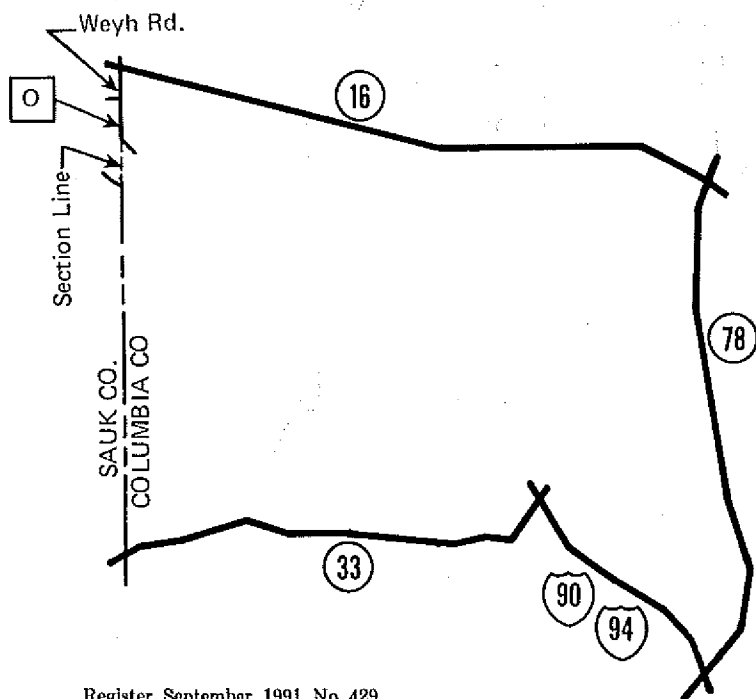

(5) THERESA ZONE.

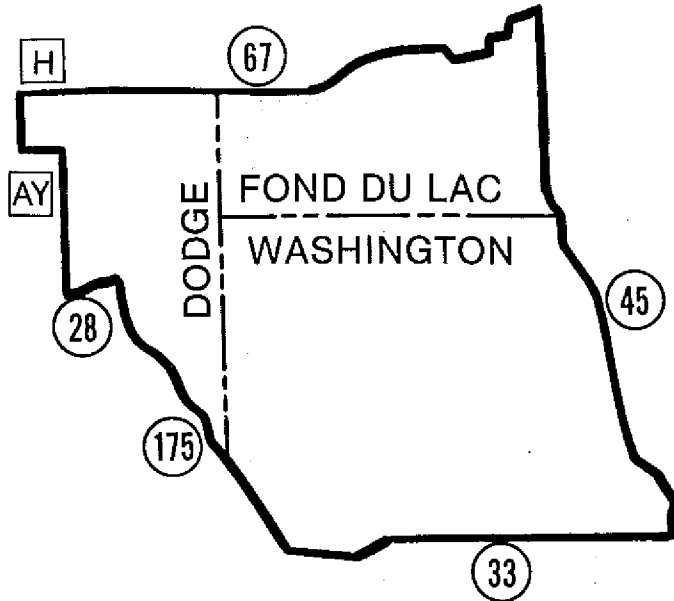

(11) EARLY GOOSE HUNT SUBZONE.

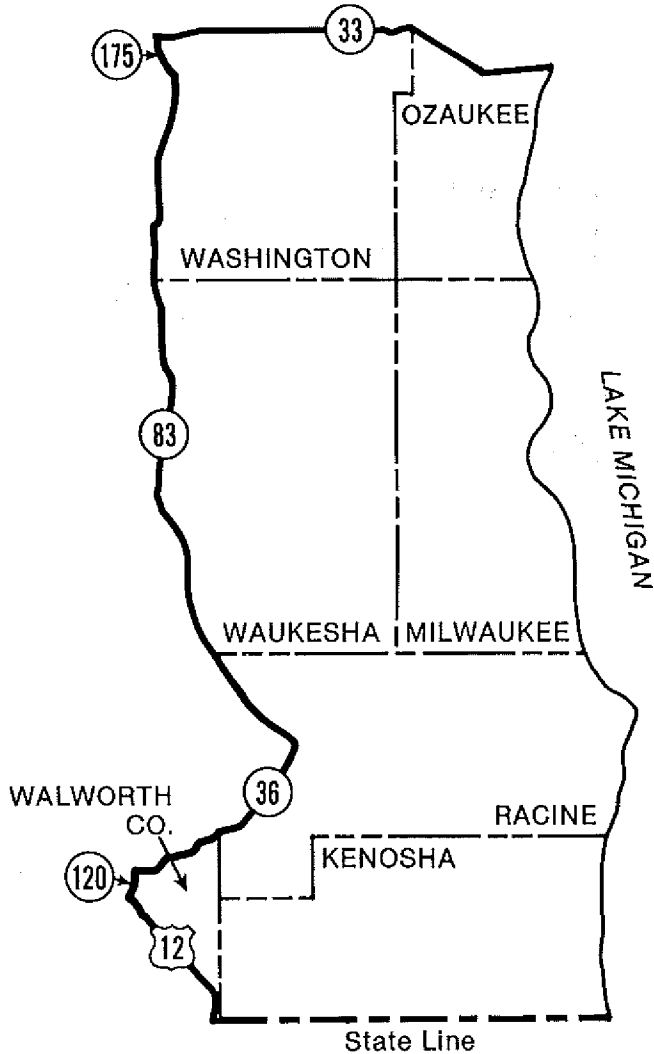

History: Cr. Register, July, 1988, No. 391, eff. 8-1-88; emerg. renum. (1) to (6) to be (1) (a), (b), (2), (3) (a), (3) (b) and (1) (c), cr. (1) (intro.), eff. 9-15-89; r. and recr. (7), Register, October, 1989, No. 406, eff. 11-1-89; renum. (1) to (10) to be (1) (a), (b), (2), (3) (a), (3) (b), (1) (c) and (d), (4), (1) (e) and (5), cr. (1) (intro.) and (3) (intro.), Register, March, 1990, No. 411, eff. 4-1-90; r. and recr. (3) (a), Register, June, 1990, No. 414, eff. 7-1-90; cr. (11), Register, July, 1990, No. 415, eff. 8-1-90; am. (2) and (3) (a), Register, September, 1991, No. 429, eff. 10-1-91.