

NR 15.024 No entry wildlife refuge (Sept. 1 - Dec. 31); gun deer hunting permitted. A wildlife refuge is established in the following areas when posted with department signs and no person may hunt waterfowl at any time, or enter such areas for any reason from September 1 through December 31, except to hunt deer during the open season for hunting deer established in ss. NR 10.01 (3) (e) and 10.117.

(1) PEAT LAKE, Township 1 north, range 20 east, town of Salem.

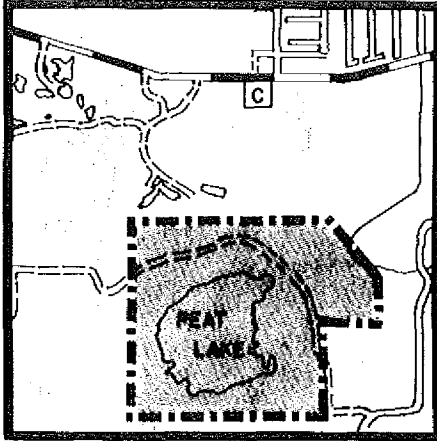

(2) RACINE COUNTY. (a) *Dover*. Township 3 north, range 20 east, town of Dover.

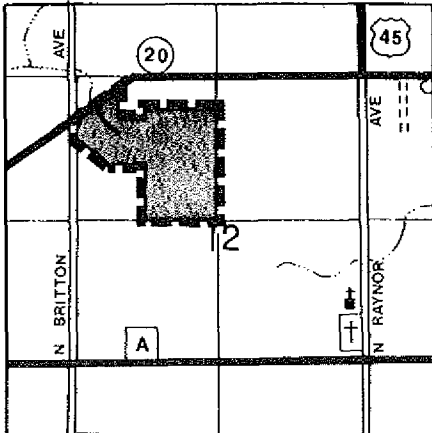

(b) *Pichigan wildlife area.* Township 4 north, range 19 east, town of Waterford.

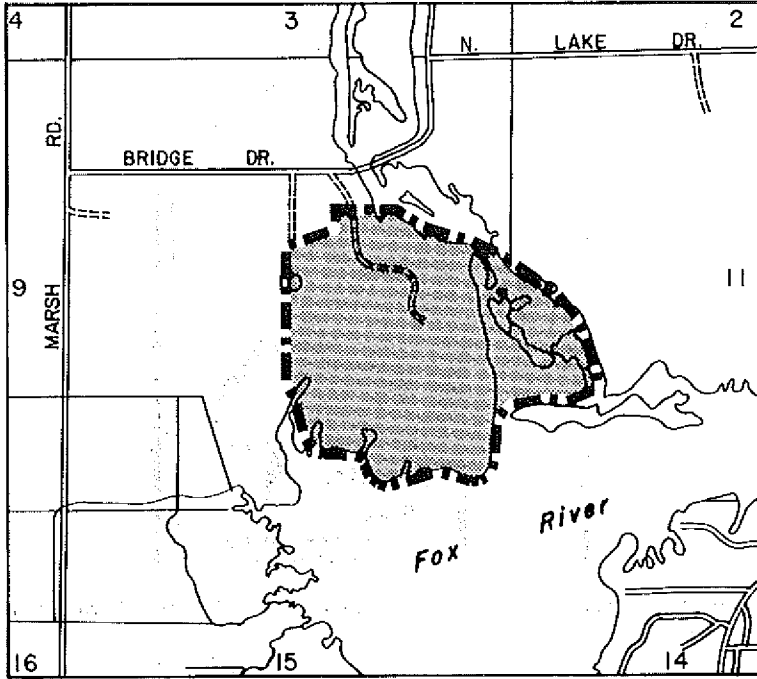

(3) WAUKESHA COUNTY. (a) *Vernon wildlife area*. Township 5 north, range 19 east, town of Vernon and township 6 north, range 19 east, town of Waukesha.

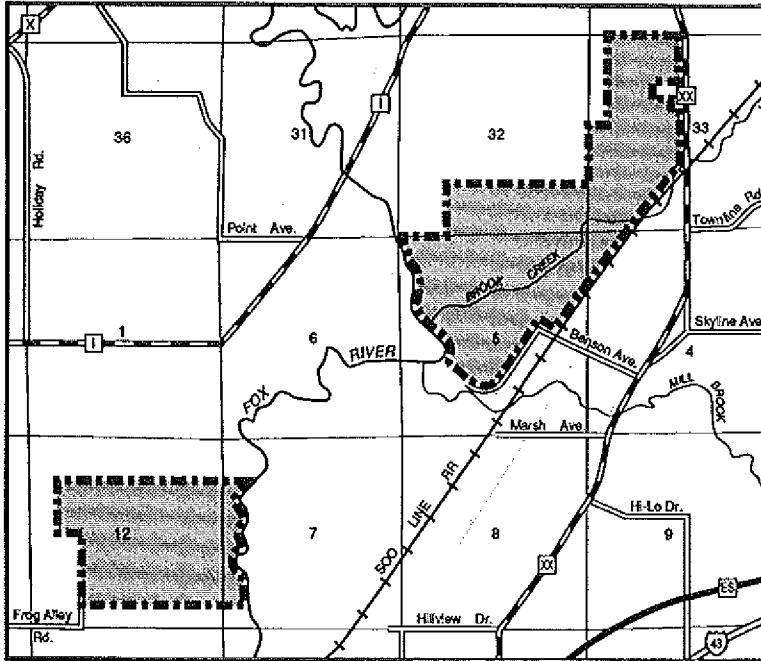

History: (1) to (3) renum. from NR 15.022 (6) (b), (8) and (11), cr. (intro.), Register, October, 1989, No. 406, eff. 11-1-89; am. (intro.), Register, October, 1990, No. 418, eff. 11-1-90; am. (3) map, Register, April, 1992, No. 436, eff. 5-1-92.

NR 15.03 No entry wildlife refuge, rookeries and special areas. A wildlife refuge is established in the following areas when posted with department signs and no person may enter upon such area for any reason from April 1 through September 15.

(1) (a) *Ashland Tern Island*. Township 48 north, range 4 west, city of Ashland.

